

90° Corner Mull Cover

Installation Instructions

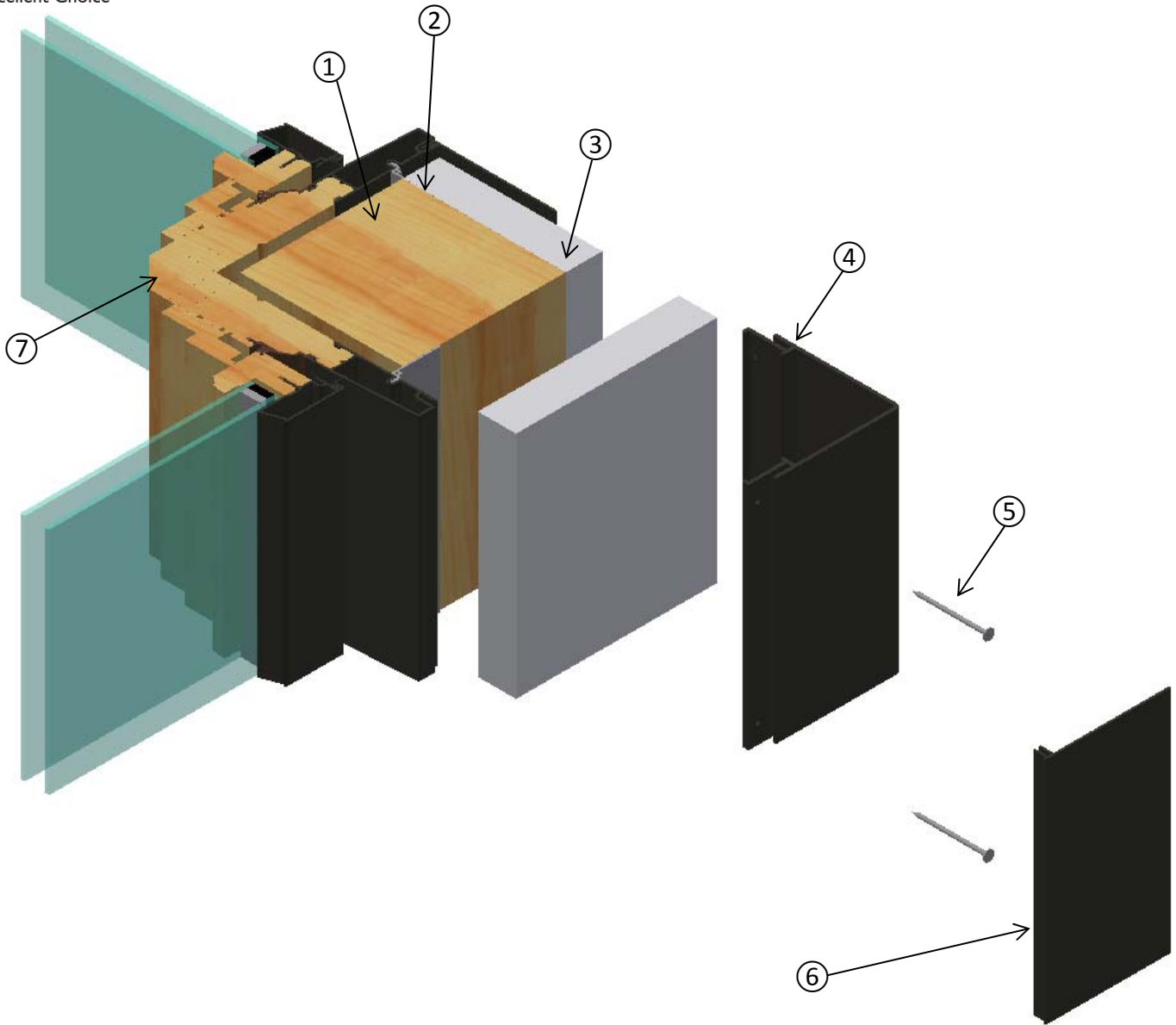

Figure 1: Corner mull post assembly.

Use Figure 1 shown above in conjunction with the steps on the following page to properly install the 90° corner mull cover.

Installation Steps:

- 1) First, assemble all structural components. Use a 4 ¼" x 4 ¼" post (by others) for corner post construction.
- 2) Insert and secure window units according to unit installation instructions.
 - a. Note: A 4 9/16" side jamb is required for proper installation.
- 3) Nail 1" thick face strip (by others) on top of nail fin and corner post.
- 4) Drill Ø1/8" holes into 90° corner mull (part #: 584023) as directed below in Figure 2.

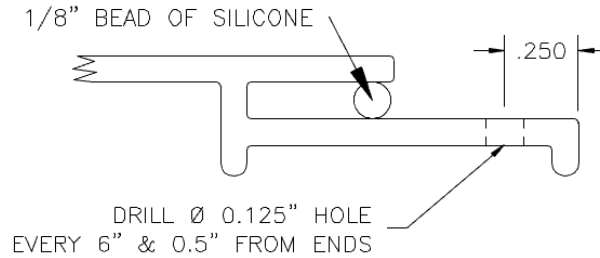

Figure 2: Nail hole location on mull cover (x2).

- 5) Position mull cover as desired on outside corner of face strip. Secure in place with one nail in each of the holes created in Step 4 (Nails by others; 6D nails are recommended).
 - a. Note: Use caution when nailing cover into place to prevent dents and chipped paint.
 - b. Apply a 1/8" bead of silicone onto mull cover as directed above in Figure 2.
 - c. Apply a 1/8" bead of silicone in accessory groove of unit as shown below in Figure 3.
- 6) Insert a 3 ¼" frame expander (sold separately; part # 480019) into mull cover and into accessory groove of unit as shown below in Figure 3.

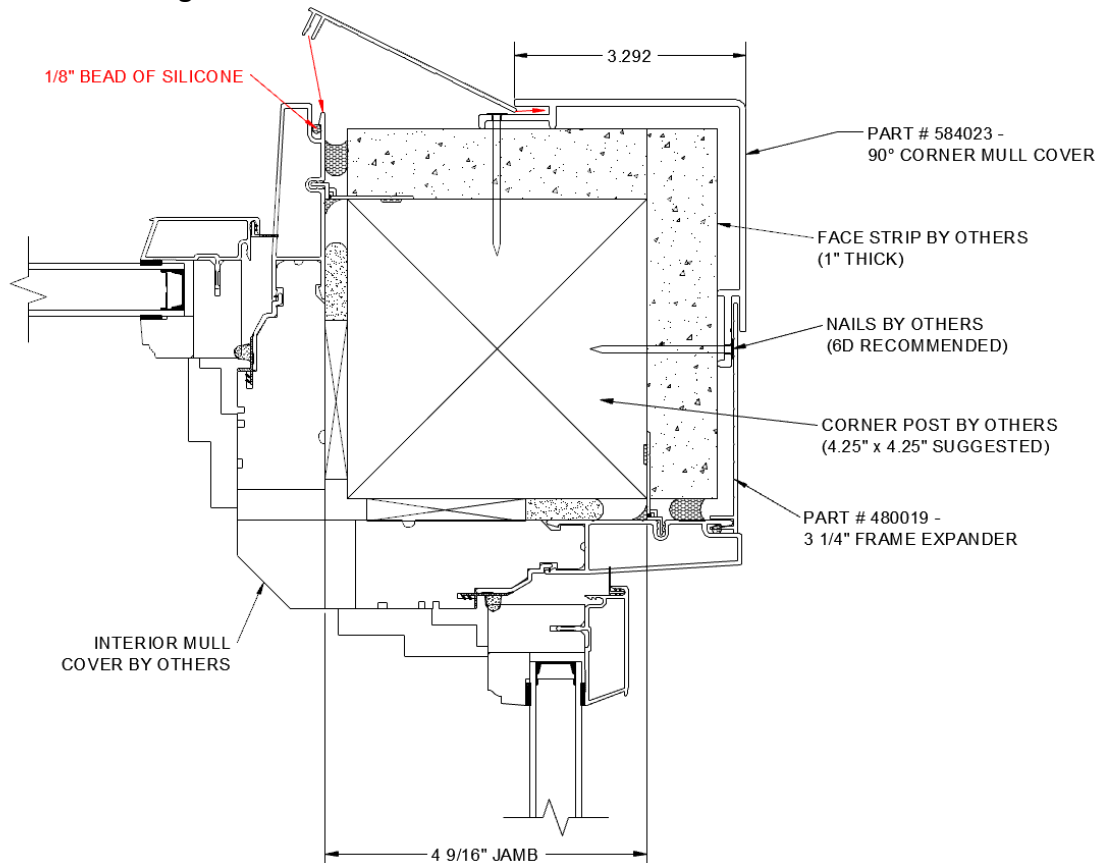

Figure 3: Frame expander installation.

- 7) Apply interior mull cover (by others) after installation is complete.