

12/22/2020 4:17 PM

s:\projects\windsor windows and doors\cc-20-0917-fbc code change (ver. 7)\dwgs\fl14884\wwd058.dwg

INSTALLATION NOTES:

1. ONE (1) INSTALLATION ANCHOR IS REQUIRED AT EACH ANCHOR LOCATION SHOWN.
2. THE NUMBER OF INSTALLATION ANCHORS DEPICTED IS THE MINIMUM NUMBER OF ANCHORS TO BE USED FOR PRODUCT INSTALLATION OF THE MAXIMUM SIZE LISTED.
3. INSTALL INDIVIDUAL INSTALLATION ANCHORS WITHIN A TOLERANCE OF ±1/2 INCH BASED ON QUANTITIES IN DP CHARTS NOT TO EXCEED THE DEPICTED LOCATION & SPACING IN THE ANCHOR LAYOUT DETAILS (I.E., WITHOUT CONSIDERATION OF TOLERANCES). TOLERANCES ARE NOT CUMULATIVE FROM ONE INSTALLATION ANCHOR TO THE NEXT
4. SHIM AS REQUIRED AT EACH INSTALLATION ANCHOR WITH LOAD BEARING SHIM(S). MAXIMUM ALLOWABLE SHIM STACK TO BE 1/4 INCH. SHIM WHERE SPACE OF 1/16 INCH OR GREATER OCCURS. SHIM(S) SHALL BE CONSTRUCTED OF HIGH DENSITY PLASTIC OR BETTER.
5. **THROUGH FRAME:** FOR INSTALLATION INTO WOOD FRAMING USE #10 WOOD SCREWS OF SUFFICIENT LENGTH TO ACHIEVE 1 1/2 INCH MINIMUM EMBEDMENT INTO WOOD SUBSTRATE.
6. **THROUGH FRAME:** FOR INSTALLATION THROUGH 1X BUCK TO CONCRETE/MASONRY, OR DIRECTLY INTO CONCRETE/MASONRY, USE 1/4 INCH DIAMETER ITW TAPCONS, ELCO ULTRACONS, ELCO CRETE-FLEX OR HILTI KWIK-CON II OF SUFFICIENT LENGTH TO ACHIEVE 1 1/4 INCH MINIMUM EMBEDMENT.
7. **THROUGH FRAME:** FOR INSTALLATION INTO METAL STUD OR APPROVED MULLION USE #10 GR. 5 SELF TAPPING SCREWS OF SUFFICIENT LENGTH TO ACHIEVE A MINIMUM OF 3 THREADS PENETRATION BEYOND METAL FRAME SUBSTRATE.
8. **CLIP ANCHOR:** FOR INSTALLATION INTO WOOD FRAMING USE (2) #8 WOOD SCREWS PER CLIP OF SUFFICIENT LENGTH TO ACHIEVE 1 1/2" MINIMUM EMBEDMENT INTO WOOD SUBSTRATE.
9. **CLIP ANCHOR:** FOR INSTALLATION INTO METAL STUD USE (2) #8 GR. 5 SELF-TAPPING SCREWS PER CLIP OF SUFFICIENT LENGTH TO ACHIEVE 3 THREADS MINIMUM PENETRATION BEYOND THE METAL STRUCTURE.
10. **NAIL FIN:** FOR INSTALLATION INTO WOOD FRAMING USE (1) #8 WOOD SCREWS OR (1) 10D COMMON NAIL OR (1) 11 GAUGE ROOFING NAIL PER LOCATION OF SUFFICIENT LENGTH TO ACHIEVE 1 1/2 INCH MINIMUM EMBEDMENT INTO WOOD SUBSTRATE.
11. **NAIL FIN:** FOR INSTALLATION INTO METAL STUD OR APPROVED MULLION USE #8 GR. 5 SELF TAPPING SCREWS OF SUFFICIENT LENGTH TO ACHIEVE A MINIMUM OF 3 THREADS PENETRATION BEYOND METAL FRAME SUBSTRATE.
12. MINIMUM EMBEDMENT AND EDGE DISTANCE EXCLUDE WALL FINISHES, INCLUDING BUT NOT LIMITED TO STUCCO, FOAM, BRICK VENEER, AND SIDING.
13. INSTALLATION ANCHORS AND ASSOCIATED HARDWARE MUST BE MADE OF CORROSION RESISTANT MATERIAL OR HAVE A CORROSION RESISTANT COATING.
14. FOR HOLLOW BLOCK AND GROUT FILLED BLOCK, DO NOT INSTALL INSTALLATION ANCHORS INTO MORTAR JOINTS. EDGE DISTANCE IS MEASURED FROM FREE EDGE OF BLOCK OR EDGE OF MORTAR JOINT INTO FACE SHELL OF BLOCK.
15. INSTALLATION ANCHORS SHALL BE INSTALLED IN ACCORDANCE WITH ANCHOR MANUFACTURER'S INSTALLATION INSTRUCTIONS, AND ANCHORS SHALL NOT BE USED IN SUBSTRATES WITH STRENGTHS LESS THAN THE MINIMUM STRENGTH SPECIFIED BY THE ANCHOR MANUFACTURER.

WINDSOR WINDOWS & DOORS

NEXT DIMENSION CLASSIC SINGLE HUNG

(NON-HVHZ) (NON-IMPACT)

CONTINUED INSTALLATION NOTES:

16. INSTALLATION ANCHOR CAPACITIES FOR PRODUCTS HEREIN ARE BASED ON SUBSTRATE MATERIALS WITH THE FOLLOWING PROPERTIES:
- A. WOOD - MINIMUM SPECIFIC GRAVITY OF 0.55.
- B. CONCRETE -MINIMUM COMPRESSIVE STRENGTH OF 3000 PSI.
- C. GROUT-FILLED CMU- UNIT STRENGTH CONFORMS TO ASTM C-90 WITH MINIMUM COMPRESSIVE STRENGTH OF 2000 PSI AND GROUT CONFORMS TO ASTM C 476, MINIMUM GROUT COMPRESSIVE STRENGTH OF 2000 PSI.
- D. HOLLOW BLOCK CMU - UNIT STRENGTH CONFORMS TO ASTM C-90 WITH MINIMUM COMPRESSIVE STRENGTH OF 2000 PSI.
- E. STEEL - MINIMUM YIELD STRENGTH OF 33 KSI. MINIMUM 18 GA. WALL THICKNESS.
- F. ALUMINUM - MINIMUM ALLOY 6063-T5. MINIMUM WALL THICKNESS OF 1/8" (0.125").

GENERAL NOTES:

1. THE PRODUCT SHOWN HEREIN IS DESIGNED AND MANUFACTURED TO COMPLY WITH THE CURRENT FLORIDA BUILDING CODE (FBC), **EXCLUDING** HVHZ AND HAS BEEN EVALUATED ACCORDING TO THE FOLLOWING:
- AAMA/WDMA/CSA 101/I.S.2/A440-08/11

AAMA 450-10
2. ADEQUACY OF THE EXISTING STRUCTURAL CONCRETE/MASONRY AND 2X FRAMING AS A MAIN WIND FORCE RESISTING SYSTEM CAPABLE OF WITHSTANDING AND TRANSFERRING APPLIED PRODUCT LOADS TO THE FOUNDATION IS THE RESPONSIBILITY OF THE ENGINEER OR ARCHITECT OF RECORD FOR THE PROJECT OF INSTALLATION.
3. 1X AND 2X BUCKS (WHEN USED) SHALL BE DESIGNED AND ANCHORED TO PROPERLY TRANSFER ALL LOADS TO THE STRUCTURE. BUCK DESIGN AND INSTALLATION IS THE RESPONSIBILITY OF THE ENGINEER OR ARCHITECT OF RECORD FOR THE PROJECT OF INSTALLATION.
4. THE INSTALLATION DETAILS DESCRIBED HEREIN ARE GENERIC AND MAY NOT REFLECT ACTUAL CONDITIONS FOR A SPECIFIC SITE. IF SITE CONDITIONS CAUSE INSTALLATION TO DEVIATE FROM THE REQUIREMENTS DETAILED HEREIN, A LICENSED ENGINEER OR ARCHITECT SHALL PREPARE SITE SPECIFIC DOCUMENTS FOR USE WITH THIS DOCUMENT IN NON-HVHZ AREAS.
5. APPROVED IMPACT PROTECTIVE SYSTEM **IS REQUIRED** ON THIS PRODUCT IN AREAS REQUIRING IMPACT RESISTANCE.
6. WINDOW FRAME MATERIAL: VINYL
7. GLASS SHALL MEET THE REQUIREMENTS OF ASTM E 1300 GLASS CHARTS. SEE SHEET 9 FOR GLAZING DETAILS.

| TABLE OF CONTENTS |  |
|-------------------|--|
| SHEET             | SHEET DESCRIPTION                                    |
| 1                 | INSTALLATION & GENERAL NOTES                         |
| 2                 | ELEVATIONS & ANCHOR LAYOUTS                          |
| 3                 | ELEVATIONS & ANCHOR LAYOUTS                          |
| 4                 | ELEVATIONS & ANCHOR LAYOUTS                          |
| 5                 | ELEVATIONS & ANCHOR LAYOUTS                          |
| 6                 | NAIL FIN INSTALLATION SECTIONS                       |
| 7                 | THROUGH FRAME & CLIP INSTALLATION SECTIONS           |
| 8                 | CLIP INSTALLATION SECTIONS                           |
| 9                 | LOCK RAIL DETAIL, MULLION DETAIL, AND GLAZING DETAIL |

| DESIGN PRESSURE TABLE |        |                 |               |                                |                       |
|-----------------------|--------|-----------------|---------------|--------------------------------|-----------------------|
| TYP. OVERALL SIZE     |        | DESIGN PRESSURE | CONFIGURATION | INSTALLATION METHOD            | MISSILE IMPACT RATING |
| WIDTH                 | HEIGHT |                 |               |                                |                       |
| 47.50"                | 83.50" | +40/-40 PSF     | O/X           | THROUGH FRAME, NAIL FIN & CLIP | NON - IMPACT          |
| 35.50"                | 95.50" | +35/-35 PSF     | O/X           |                                |                       |
| 95.50"                | 83.50" | +35/-35 PSF     | O/X           |                                |                       |
| 107.50"               | 83.50" | +35/-35 PSF     | O/X           |                                |                       |
| 35.50"                | 71.50" | +50/-50 PSF     | O/X           |                                |                       |



WINDSOR WINDOWS & DOORS

900 S. 19TH STREET.  
WEST DES MOINES, IA 50265  
PH: (515)223-6660 FAX: (515)224-1938

TITLE: NEXT DIMENSION CLASSIC SINGLE HUNG (NON-HVHZ)(NON-IMPACT)

INSTALLATION AND GENERAL NOTES

PREPARED BY:

BUILDING DROPS, INC.

398 E. DANIA BEACH BLVD., STE. 338

DANIA BEACH, FL 33004

PH: (954)399-8478

FAX: (954)744-4738

WEB: www.buildingdrops.com



| REMARKS | BY | DATE |
|---------|----|------|
|         |    |      |
|         |    |      |
|         |    |      |
|         |    |      |

THE INSTALLATION DETAILS DESCRIBED HEREIN ARE GENERIC AND MAY NOT REFLECT ACTUAL CONDITIONS FOR A SPECIFIC SITE. IF SITE CONDITIONS CAUSE INSTALLATION TO DEVIATE FROM THE REQUIREMENTS DETAILED HEREIN, A LICENSED ENGINEER OR ARCHITECT SHALL PREPARE SITE SPECIFIC DOCUMENTS FOR USE WITH THIS DOCUMENT.

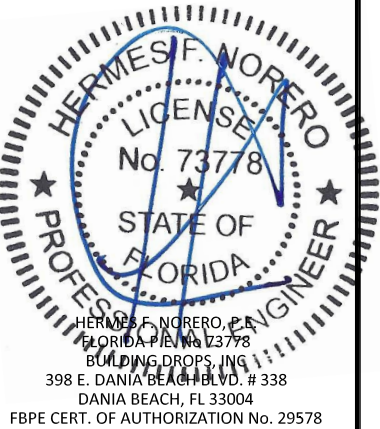

FL #:

FL14884

DATE: 11.02.20

DWG. BY: NUS

CHK. BY: HFN

SCALE: NTS

DWG. #: WWD058

SHEET:

1

OF 9

12/22/2020 4:17 PM

s:\projects\windor windows and doors\cc-20-0917-fbc code change (ver. 7)\dwgs\114884\wwd058.dwg

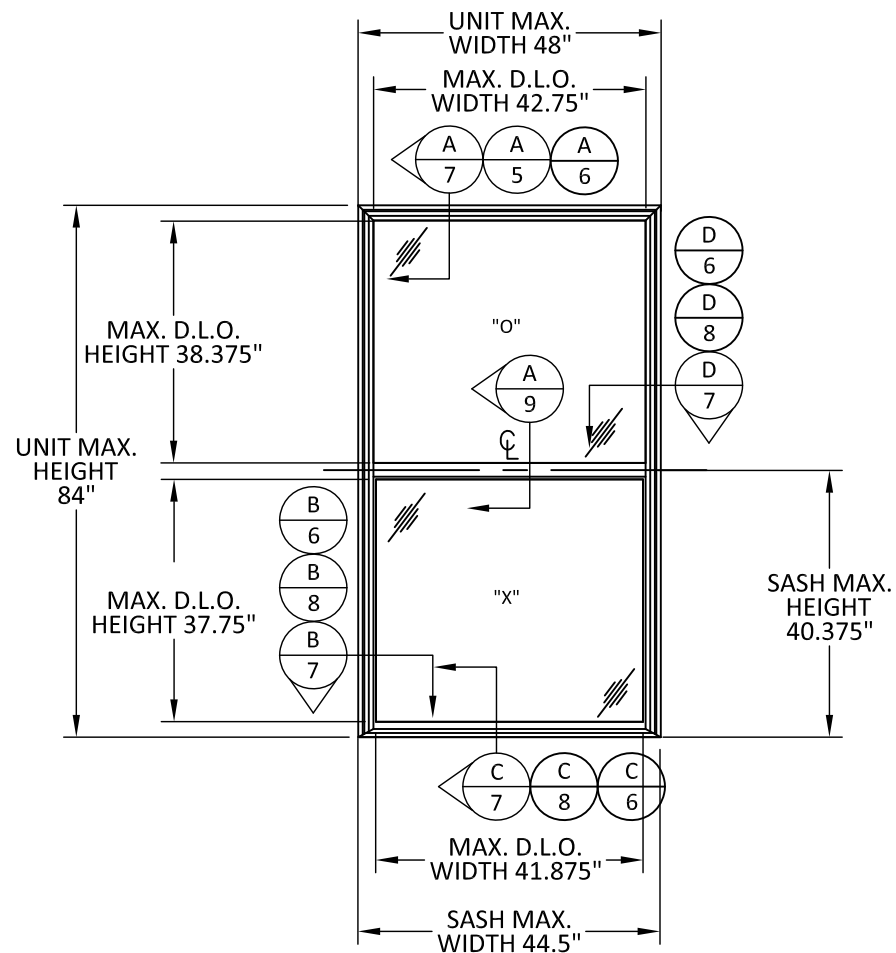

## TYPICAL ELEVATION

NEXT DIMENSION CLASSIC SINGLE HUNG

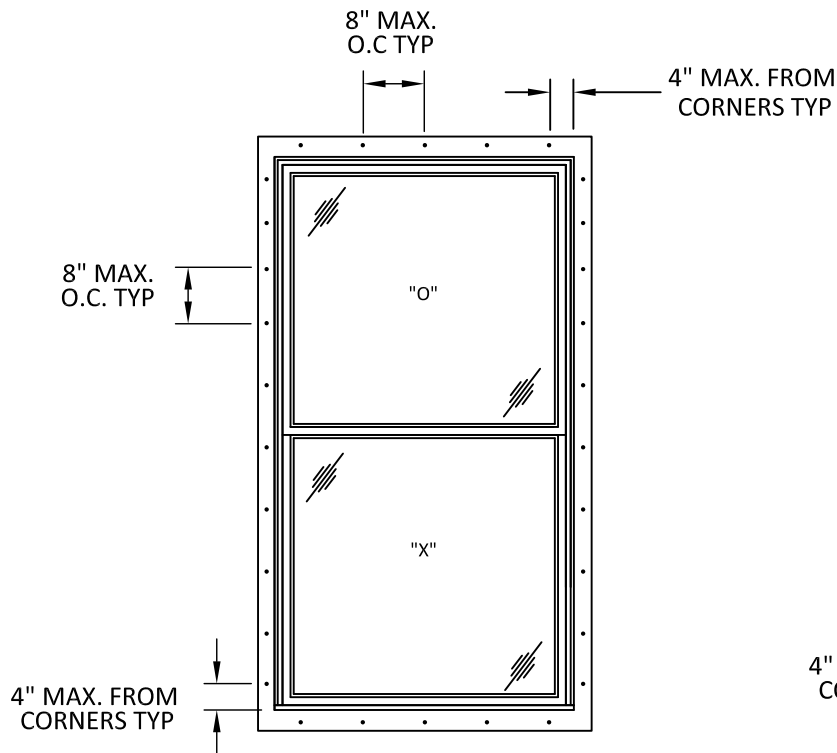

## ANCHOR LAYOUT

NAIL FIN INSTALLATION

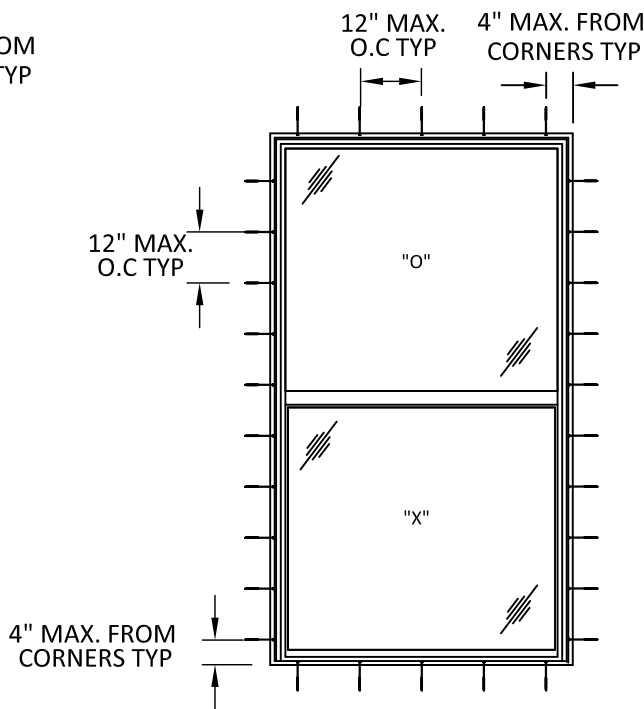

## ANCHOR LAYOUT

SCREW OR CLIP INSTALLATION



### WINDSOR WINDOWS & DOORS

900 S. 19TH STREET.  
WEST DES MOINES, IA 50265  
PH: (515)223-6660 FAX: (515)224-1938

TITLE: NEXT DIMENSION CLASSIC  
SINGLE HUNG  
(NON-HVHZ)(NON-IMPACT)  
ELEVATIONS & ANCHOR LAYOUTS

PREPARED BY:  
**BUILDING DROPS, INC.**  
398 E. DANIA BEACH BLVD., STE. 338  
DANIA BEACH, FL 33004  
PH: (954)399-8478  
FAX: (954)744-4738  
WEB: www.buildingdrops.com



| REMARKS | BY | DATE |
|---------|----|------|
|         |    |      |
|         |    |      |
|         |    |      |
|         |    |      |

THE INSTALLATION DETAILS DESCRIBED HEREIN ARE GENERIC AND MAY NOT REFLECT ACTUAL CONDITIONS FOR A SPECIFIC SITE. IF SITE CONDITIONS CAUSE INSTALLATION TO DEVIATE FROM THE REQUIREMENTS DETAILED HEREIN, A LICENSED ENGINEER OR ARCHITECT SHALL PREPARE SITE SPECIFIC DOCUMENTS FOR USE WITH THIS DOCUMENT.

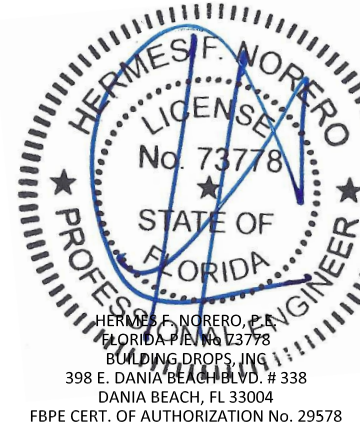

FL #:  
**FL14884**

DATE: **11.02.20**

DWG. BY: **NUS**      CHK. BY: **HFN**

SCALE: **NTS**

DWG. #: **WWD058**

SHEET:  
**2**  
OF 9



WINDSOR WINDOWS  
& DOORS

900 S. 19TH STREET.  
WEST DES MOINES, IA 50265  
PH: (515)223-6660 FAX: (515)224-1938

TITLE: NEXT DIMENSION CLASSIC  
SINGLE HUNG  
(NON-HVHZ)(NON-IMPACT)  
ELEVATIONS & ANCHOR LAYOUTS

PREPARED BY:

BUILDING DROPS, INC.  
398 E. DANIA BEACH BLVD., STE. 338  
DANIA BEACH, FL 33004  
PH: (954)399-8478  
FAX: (954)744-4738  
WEB: www.buildingdrops.com



| REMARKS | BY | DATE |
|---------|----|------|
|         |    |      |
|         |    |      |
|         |    |      |
|         |    |      |

THE INSTALLATION DETAILS DESCRIBED HEREIN ARE GENERIC  
AND MAY NOT REFLECT ACTUAL CONDITIONS FOR A SPECIFIC  
SITE. IF SITE CONDITIONS CAUSE INSTALLATION TO DEVIATE  
FROM THE REQUIREMENTS DETAILED HEREIN, A LICENSED  
ENGINEER OR ARCHITECT SHALL PREPARE SITE SPECIFIC  
DOCUMENTS FOR USE WITH THIS DOCUMENT.

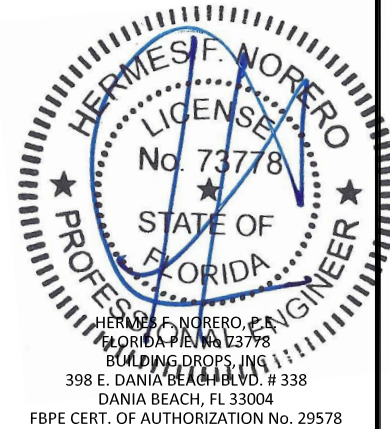

FL #:  
**FL14884**

DATE: **11.02.20**

DWG. BY: **NUS** CHK. BY: **HFN**

SCALE: **NTS**

DWG. #: **WWD058**

SHEET:  
**3**

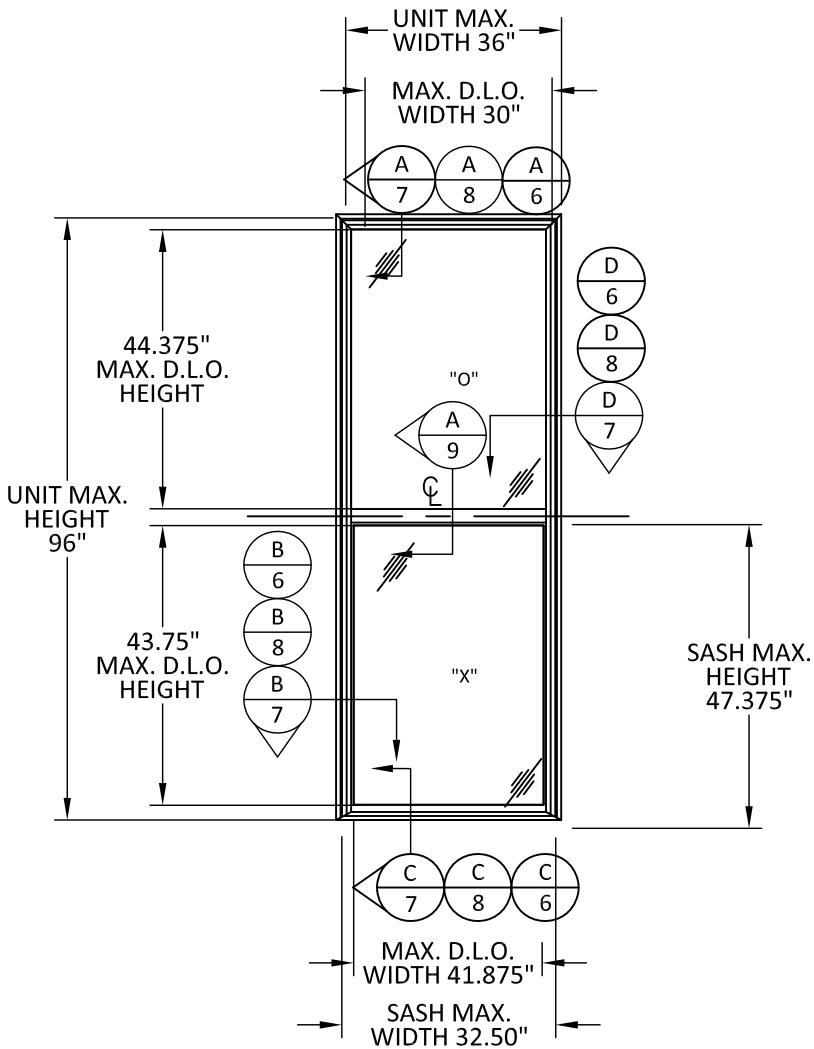

**TYPICAL ELEVATION**

NEXT DIMENSION CLASSIC SINGLE HUNG

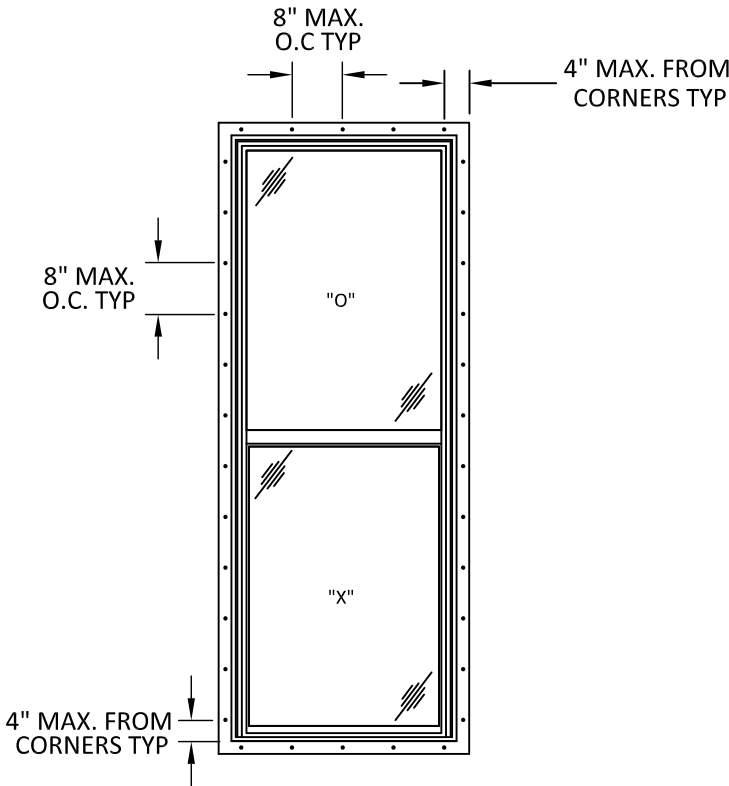

**ANCHOR LAYOUT**

NAIL FIN INSTALLATION

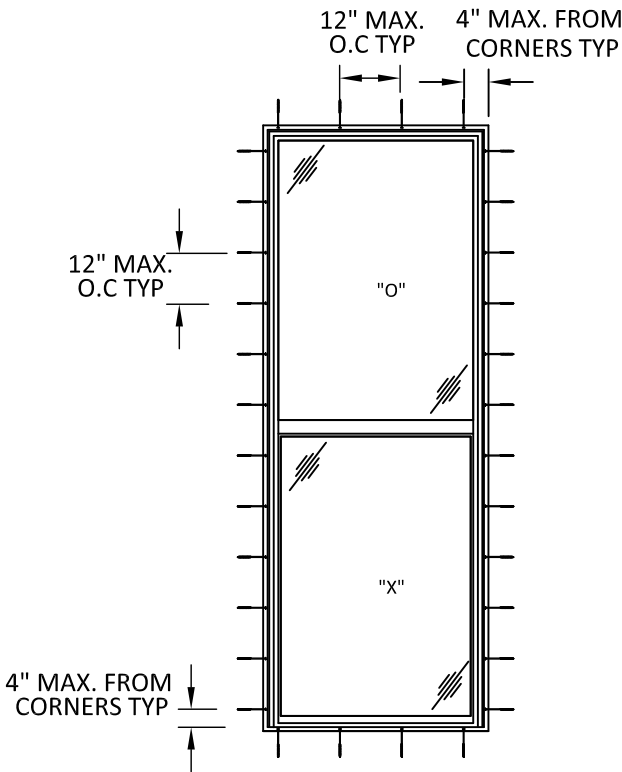

**ANCHOR LAYOUT**

SCREW OR CLIP INSTALLATION

## ELEVATIONS & ANCHOR LAYOUTS

BUILDING DROPS, INC.

8 E. DANIA BEACH BLVD., STE. 338  
DANIA BEACH, FL 33004  
PH: (954)399-8478  
FAX: (954)744.4738  
WEB: [www.buildingdrops.com](http://www.buildingdrops.com)



| REMARKS | BY | DATE |
|---------|----|------|
|         |    |      |
|         |    |      |
|         |    |      |
|         |    |      |

THE INSTALLATION DETAILS DESCRIBED HEREIN ARE GENERAL IN NATURE AND MAY NOT REFLECT ACTUAL CONDITIONS FOR A SPECIFIC SITE. IF SITE CONDITIONS CAUSE INSTALLATION TO DEVIATE FROM THE REQUIREMENTS DETAILED HEREIN, A LICENSED ENGINEER OR ARCHITECT SHALL PREPARE SITE SPECIFIC DOCUMENTS FOR USE WITH THIS DOCUMENT.

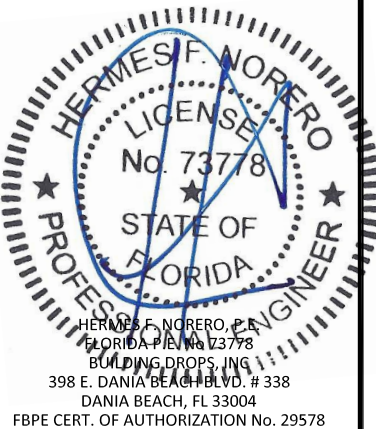

FL #:

FL14884

DATE: 11.02.20

DWG. BY:  
**NUS**

HK. BY:  
HFN

SCALE: NTS

DWG. #: WWD058

SHEET:

4

OF 9

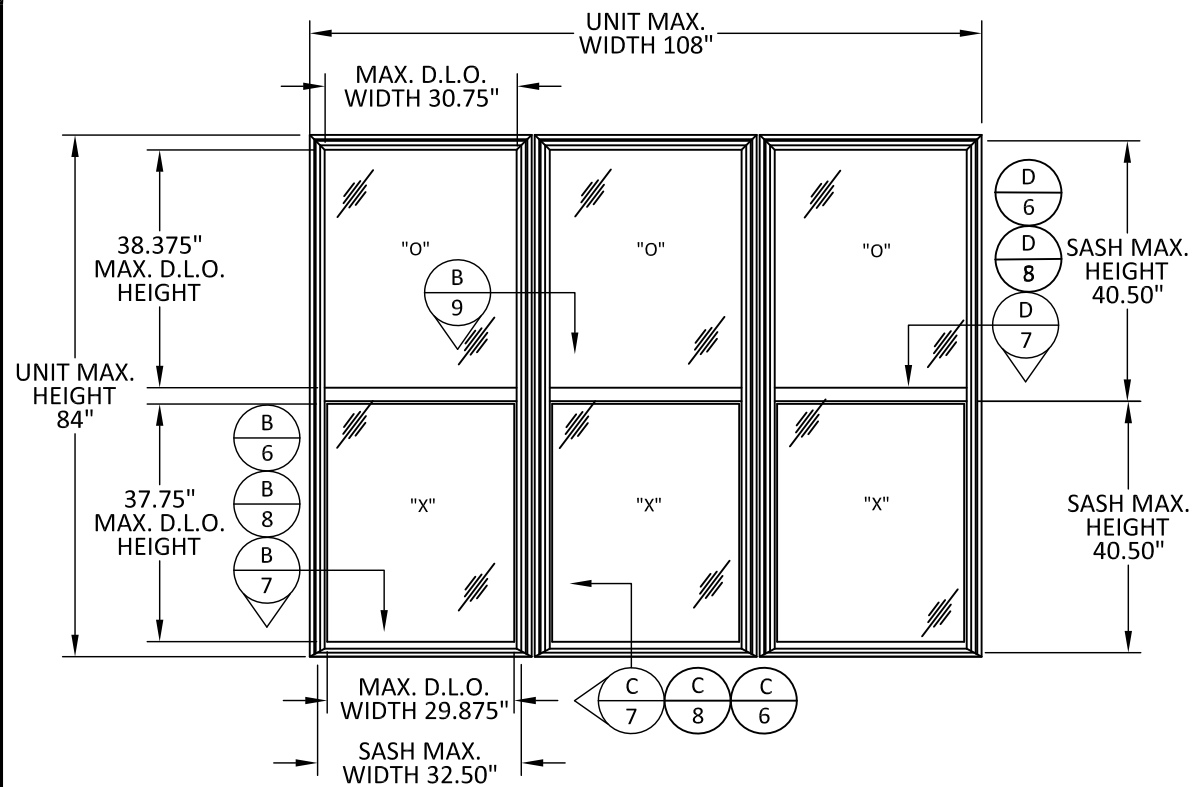

## TYPICAL ELEVATION

NEXT DIMENSION CLASSIC 3-WIDE SINGLE HUNG

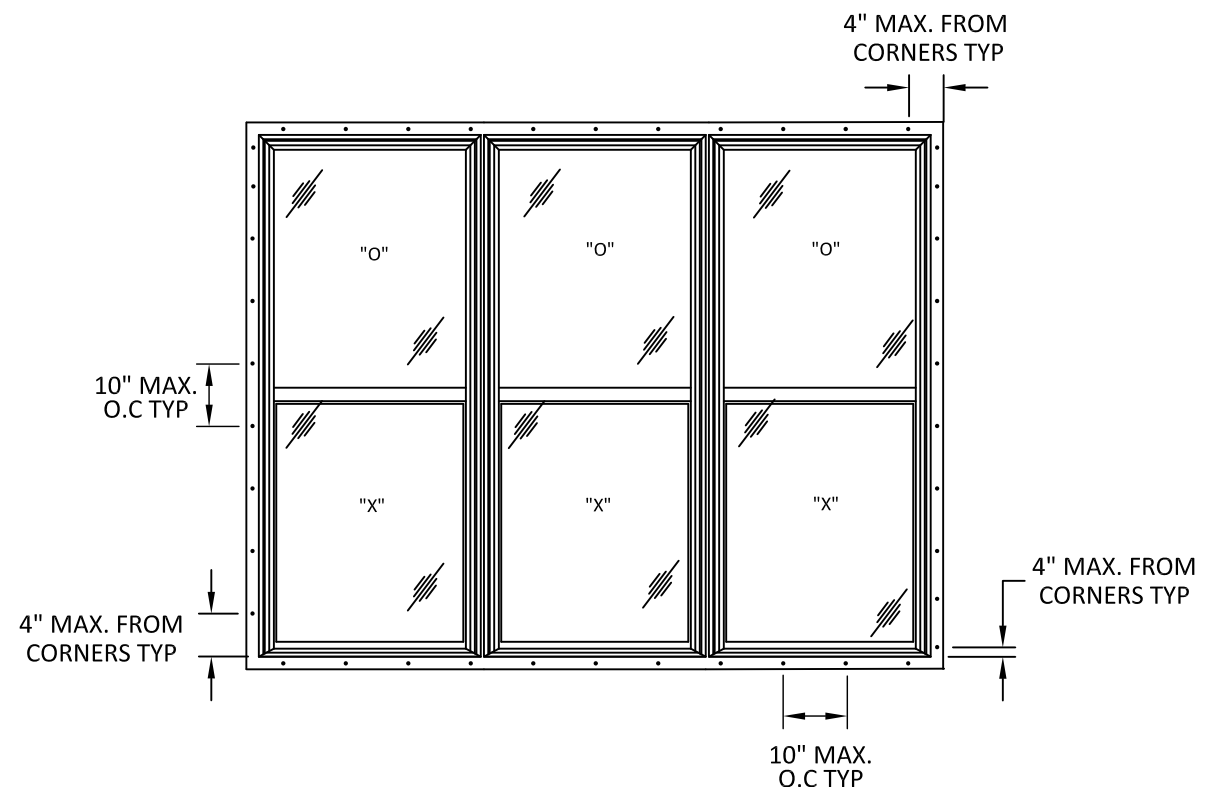

## ANCHOR LAYOUT

## NAIL FIN INSTALLATION

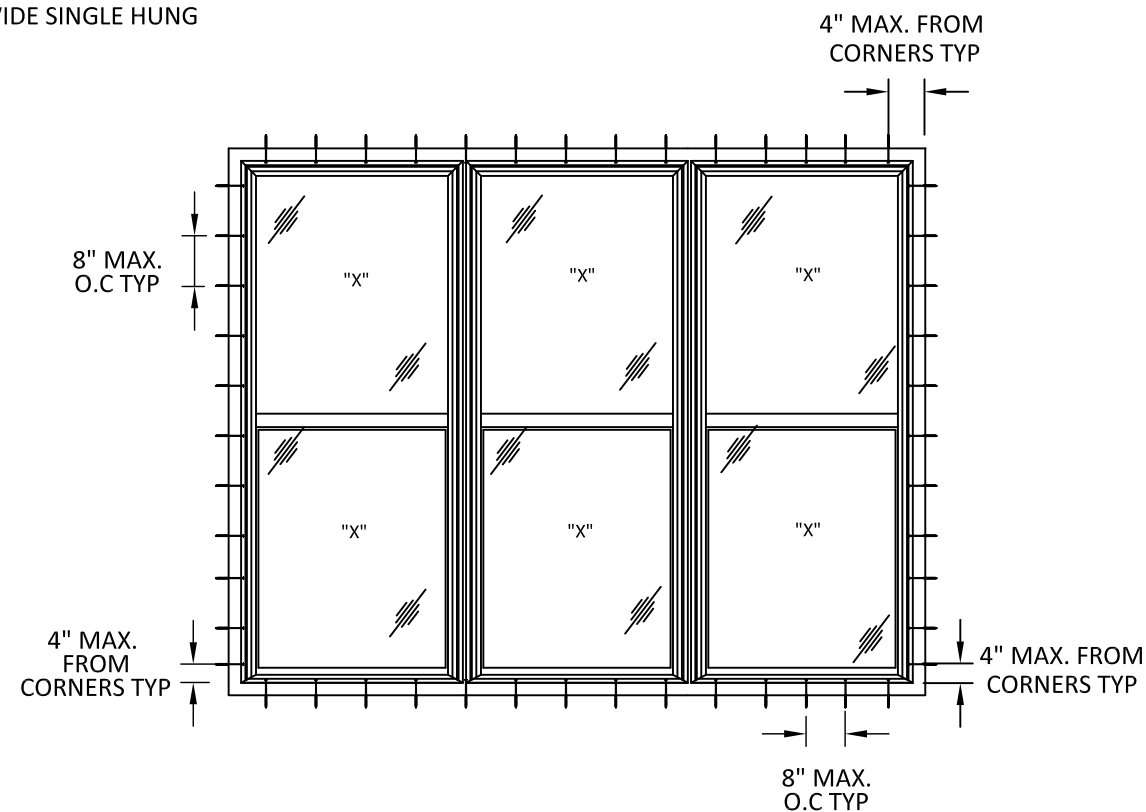

## ANCHOR LAYOUT

## SCREW OR CLIP INSTALLATION



12/22/2020 4:18 PM

s:\projects\windsor windows and doors\cc-20-0917-fbc code change (ver. 7)\dwgs\114884\wwd058.dwg

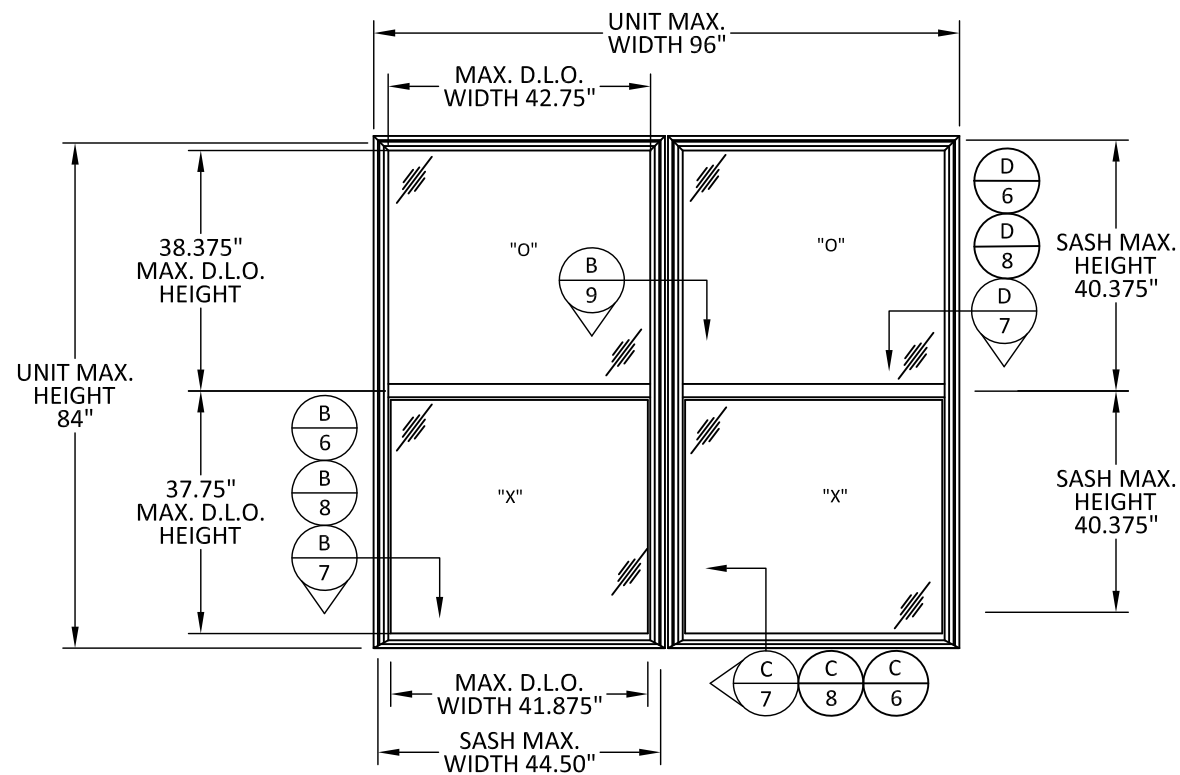

### TYPICAL ELEVATION

NEXT DIMENSION CLASSIC 2-WIDE SINGLE HUNG

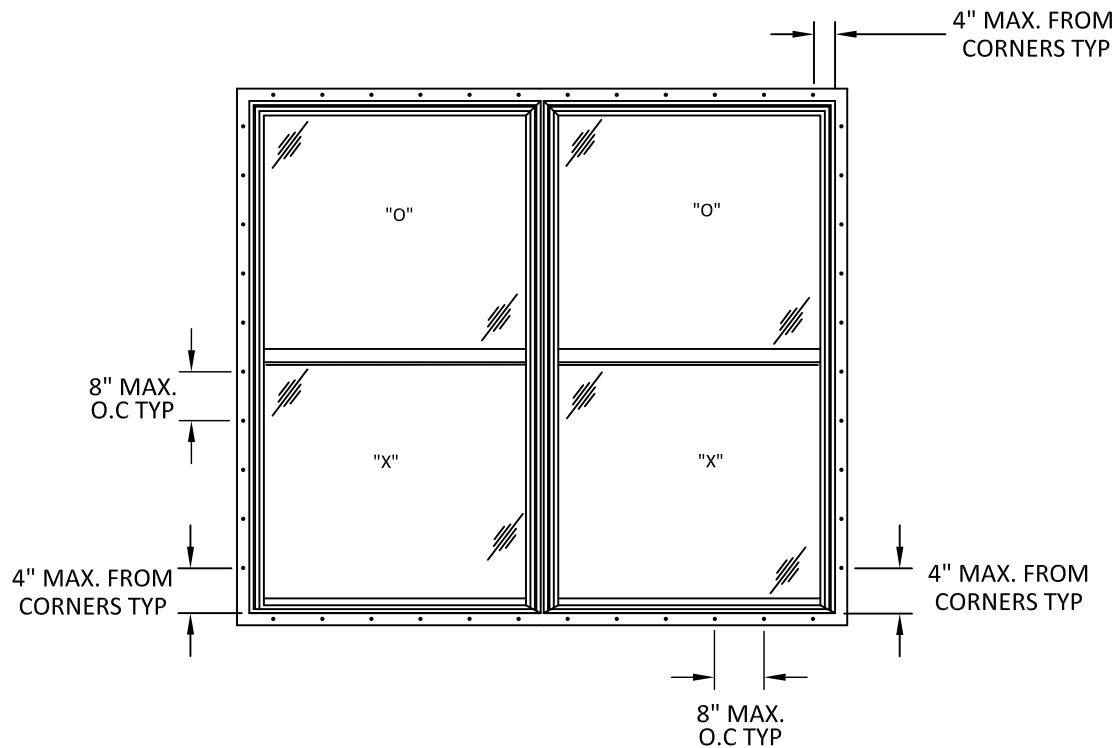

### ANCHOR LAYOUT

NAIL FIN INSTALLATION

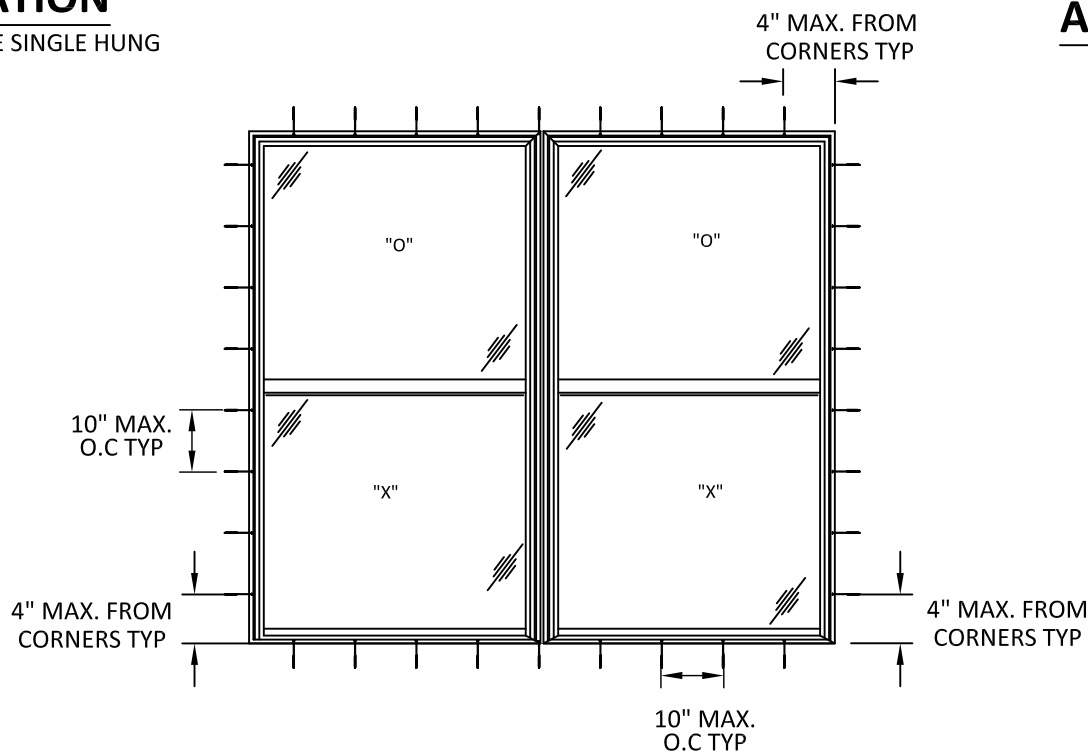

### ANCHOR LAYOUT

SCREW OR CLIP INSTALLATION



#### WINDSOR WINDOWS & DOORS

900 S. 19TH STREET.  
WEST DES MOINES, IA 50265  
PH: (515)223-6660 FAX: (515)224-1938

TITLE: NEXT DIMENSION CLASSIC  
SINGLE HUNG  
(NON-HVHZ)(NON-IMPACT)  
ELEVATIONS & ANCHOR LAYOUTS

PREPARED BY:  
BUILDING DROPS, INC.

398 E. DANIA BEACH BLVD., STE. 338  
DANIA BEACH, FL 33004  
PH: (954)399-8478  
FAX: (954)744-4738  
WEB: www.buildingdrops.com



| REMARKS | BY | DATE |
|---------|----|------|
|         |    |      |
|         |    |      |
|         |    |      |
|         |    |      |

THE INSTALLATION DETAILS DESCRIBED HEREIN ARE GENERIC AND MAY NOT REFLECT ACTUAL CONDITIONS FOR A SPECIFIC SITE. IF SITE CONDITIONS CAUSE INSTALLATION TO DEVIATE FROM THE REQUIREMENTS DETAILED HEREIN, A LICENSED ENGINEER OR ARCHITECT SHALL PREPARE SITE SPECIFIC DOCUMENTS FOR USE WITH THIS DOCUMENT.

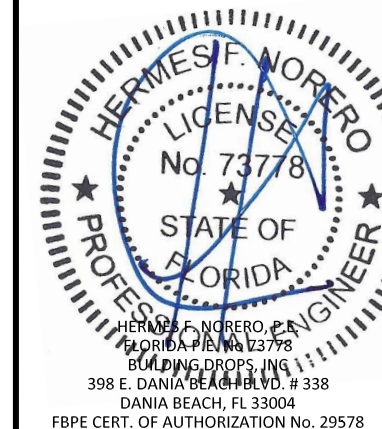

FL #:  
**FL14884**

DATE: **11.02.20**

DWG. BY: **NUS** CHK. BY: **HFN**

SCALE: **NTS**

DWG. #: **WWD058**

SHEET:  
**5**

12/22/2020 4:18 PM

s:\projects\windsor windows and doors\cc-20-0917-fbc code change (ver. 7)\dwgs\114884\wwd058.dwg

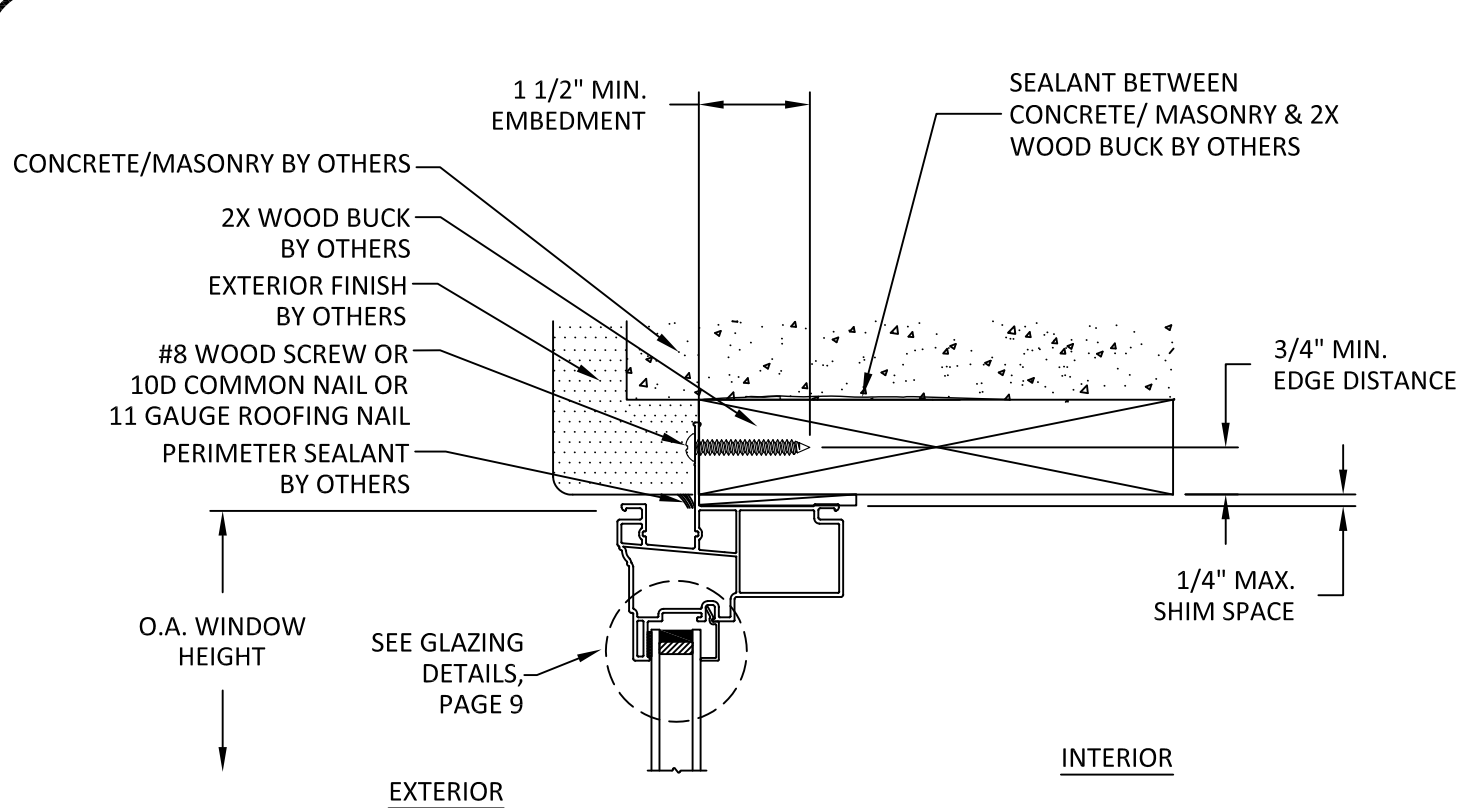

**A**  
**6** **VERTICAL SECTION**  
HEAD - 2X WOOD BUCK  
NAIL FIN INSTALLATION

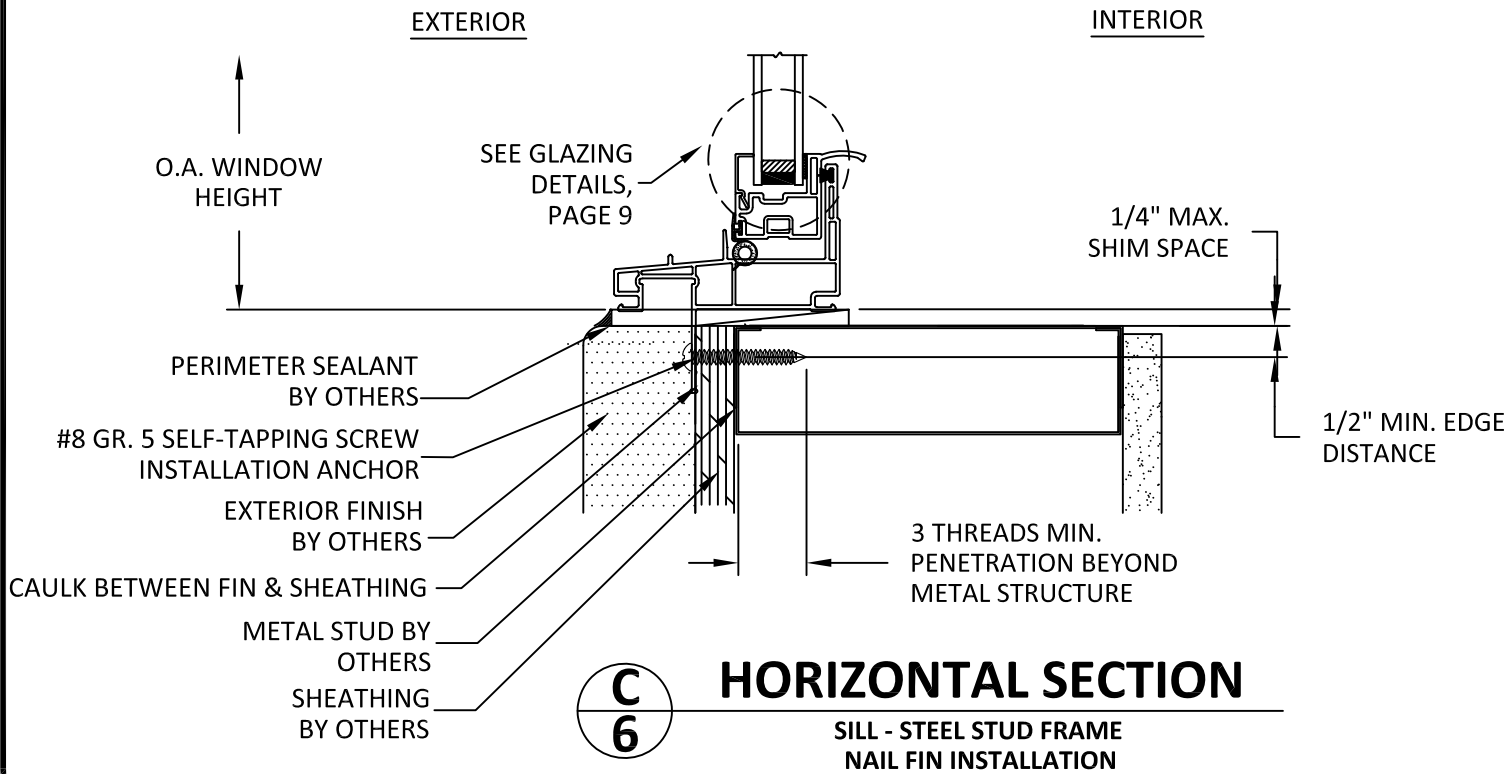

**C**  
**6** **HORIZONTAL SECTION**  
SILL - STEEL STUD FRAME  
NAIL FIN INSTALLATION

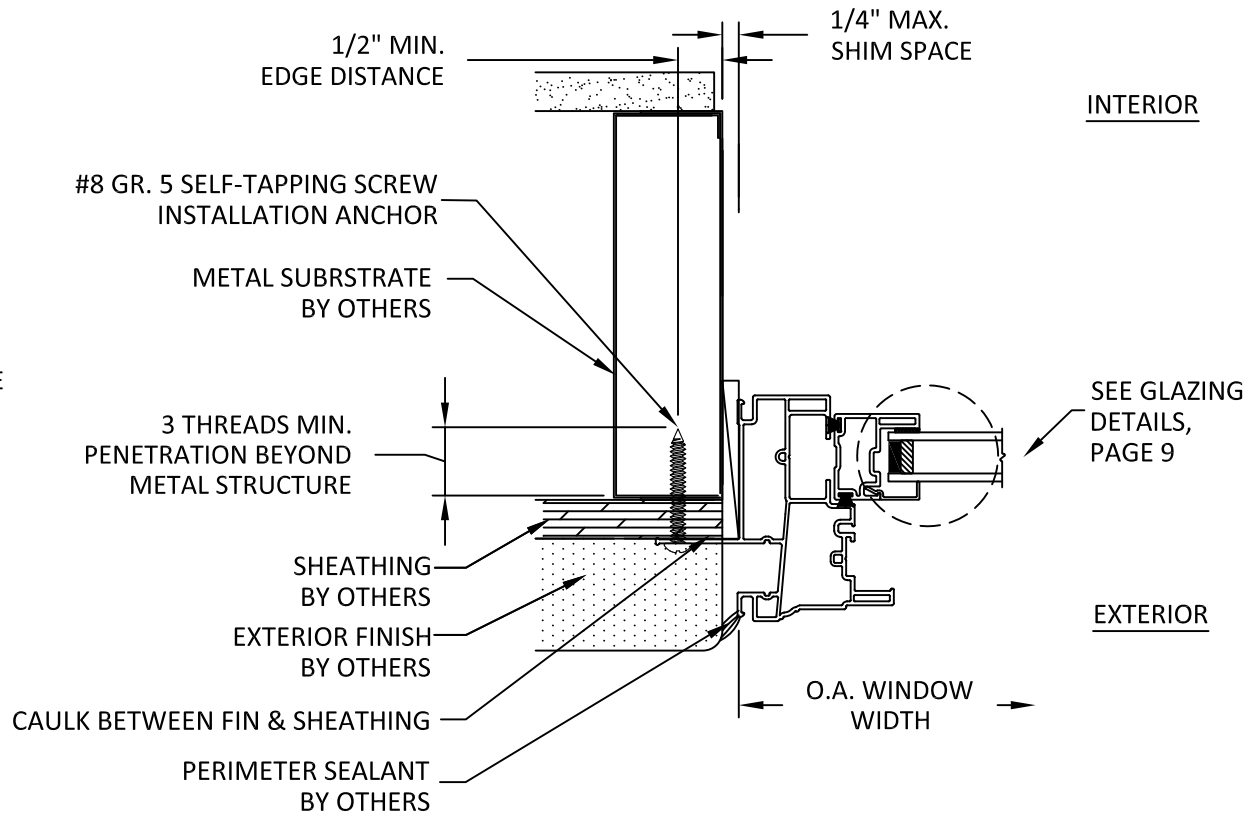

**B**  
**6** **HORIZONTAL SECTION**  
JAMB - STEEL STUD FRAME  
NAIL FIN INSTALLATION

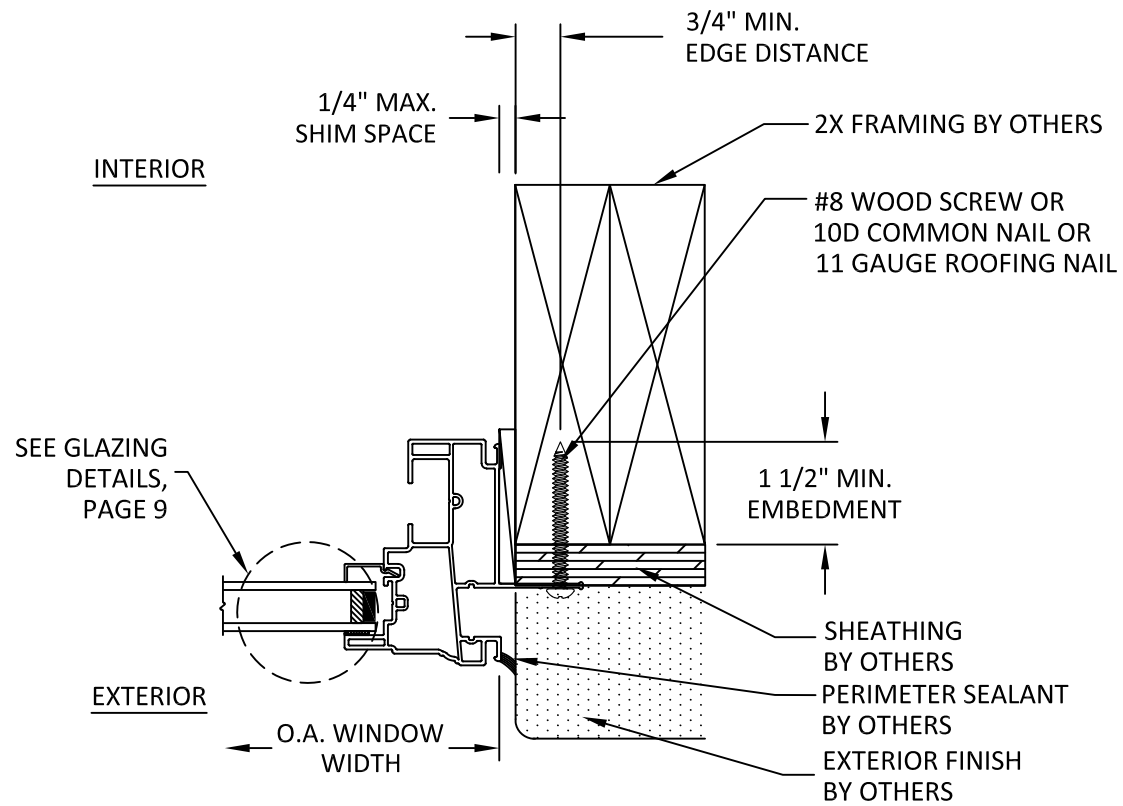

**D**  
**6** **HORIZONTAL SECTION**  
JAMB - 2X FRAMING  
NAIL FIN INSTALLATION



**WINDSOR WINDOWS  
& DOORS**

900 S. 19TH STREET.  
WEST DES MOINES, IA 50265  
PH: (515)223-6660 FAX: (515)224-1938

TITLE: NEXT DIMENSION CLASSIC  
SINGLE HUNG  
(NON-HVHZ)(NON-IMPACT)

NAIL FIN INSTALLATION  
SECTIONS

PREPARED BY:

**BUILDING DROPS, INC.**

398 E. DANIA BEACH BLVD., STE. 338  
DANIA BEACH, FL 33004  
PH: (954)399-8478  
FAX: (954)744-4738  
WEB: www.buildingdrops.com



| REMARKS | BY | DATE |
|---------|----|------|
|         |    |      |
|         |    |      |
|         |    |      |
|         |    |      |

THE INSTALLATION DETAILS DESCRIBED HEREIN ARE GENERIC  
AND MAY NOT REFLECT ACTUAL CONDITIONS FOR A SPECIFIC  
SITE. IF SITE CONDITIONS CAUSE INSTALLATION TO DEVIATE  
FROM THE REQUIREMENTS DETAILED HEREIN, A LICENSED  
ENGINEER OR ARCHITECT SHALL PREPARE SITE SPECIFIC  
DOCUMENTS FOR USE WITH THIS DOCUMENT.

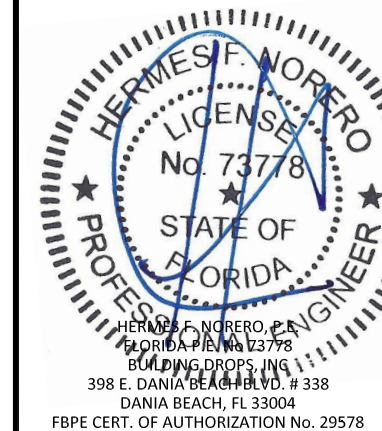

|          |                 |
|----------|-----------------|
| FL #:    | <b>FL14884</b>  |
| DATE:    | <b>11.02.20</b> |
| DWG. BY: | <b>NUS</b>      |
| CHK. BY: | <b>HFN</b>      |
| SCALE:   | <b>NTS</b>      |
| DWG. #:  | <b>WWD058</b>   |
| SHEET:   | <b>6</b>        |

12/22/2020 4:18 PM

s:\projects\windsor windows and doors\cc-20-0917-fbc code change (ver. 7)\dwgs\fl14884\wwd058.dwg

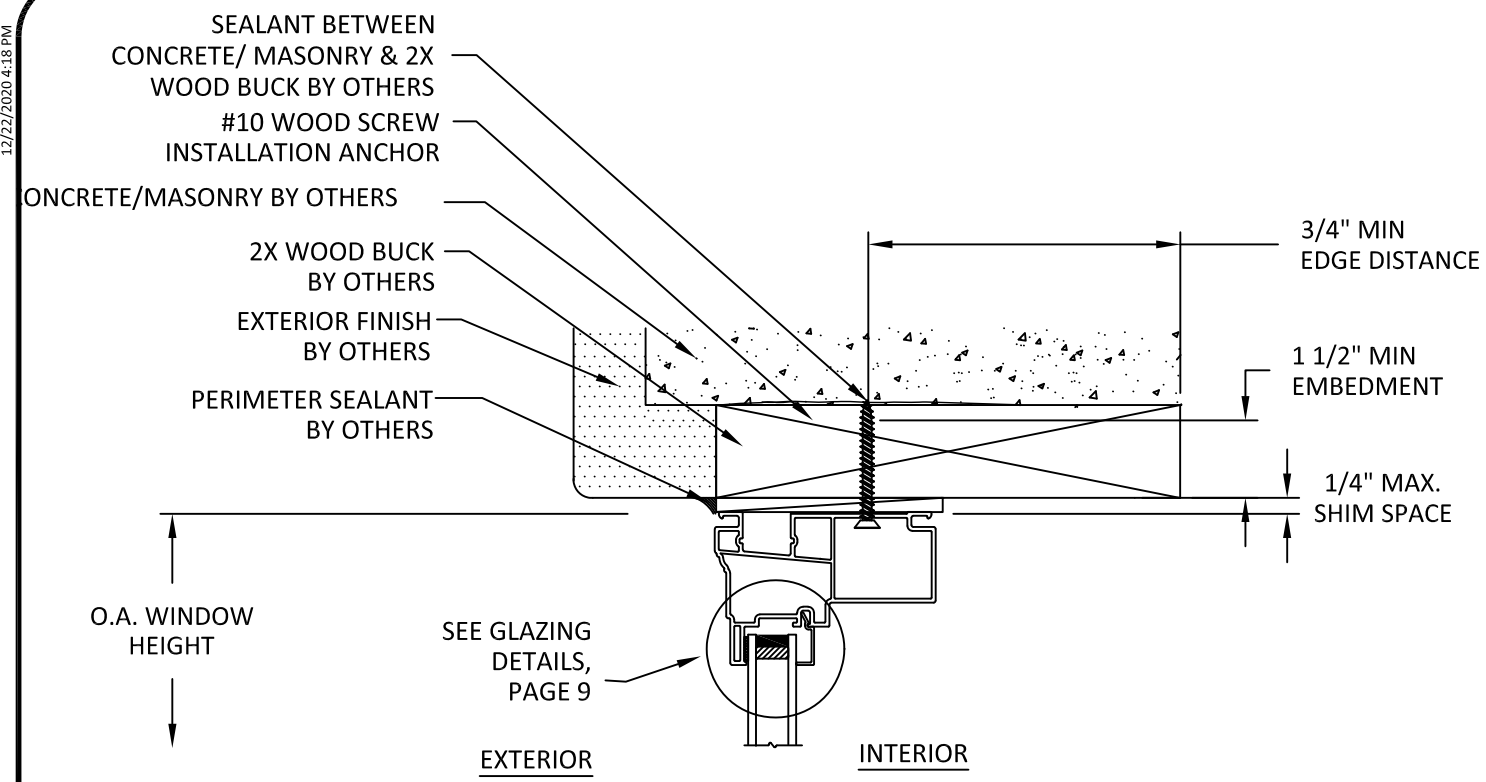

**A**  
**7**  
**VERTICAL SECTION**  
HEAD - 2X WOOD BUCK  
THROUGH FRAME INSTALLATION

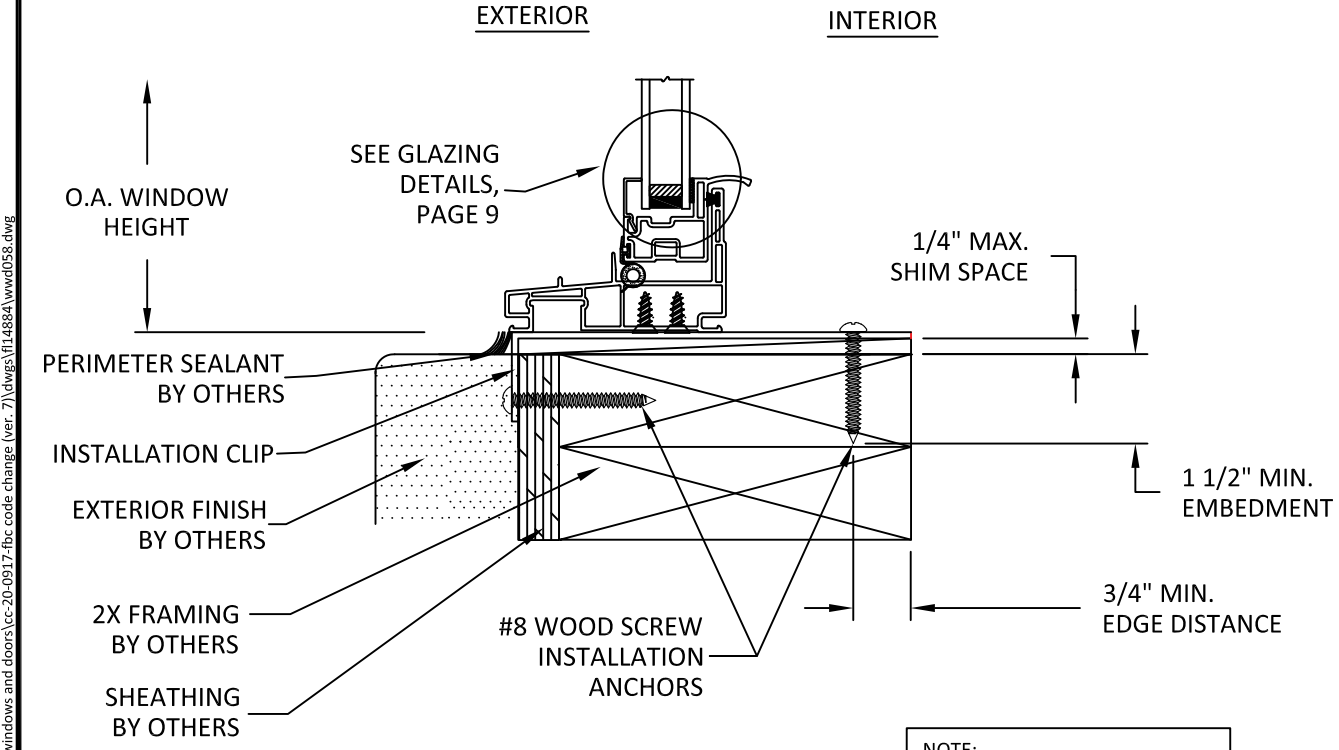

**C**  
**7**  
**VERTICAL SECTION**  
SILL - 2X FRAMING  
CLIP FRAME INSTALLATION

NOTE:  
INSTALLATION AT SILL SHALL USE  
CLIPS. THROUGH FRAME  
INSTALLATION NOT PERMITTED.

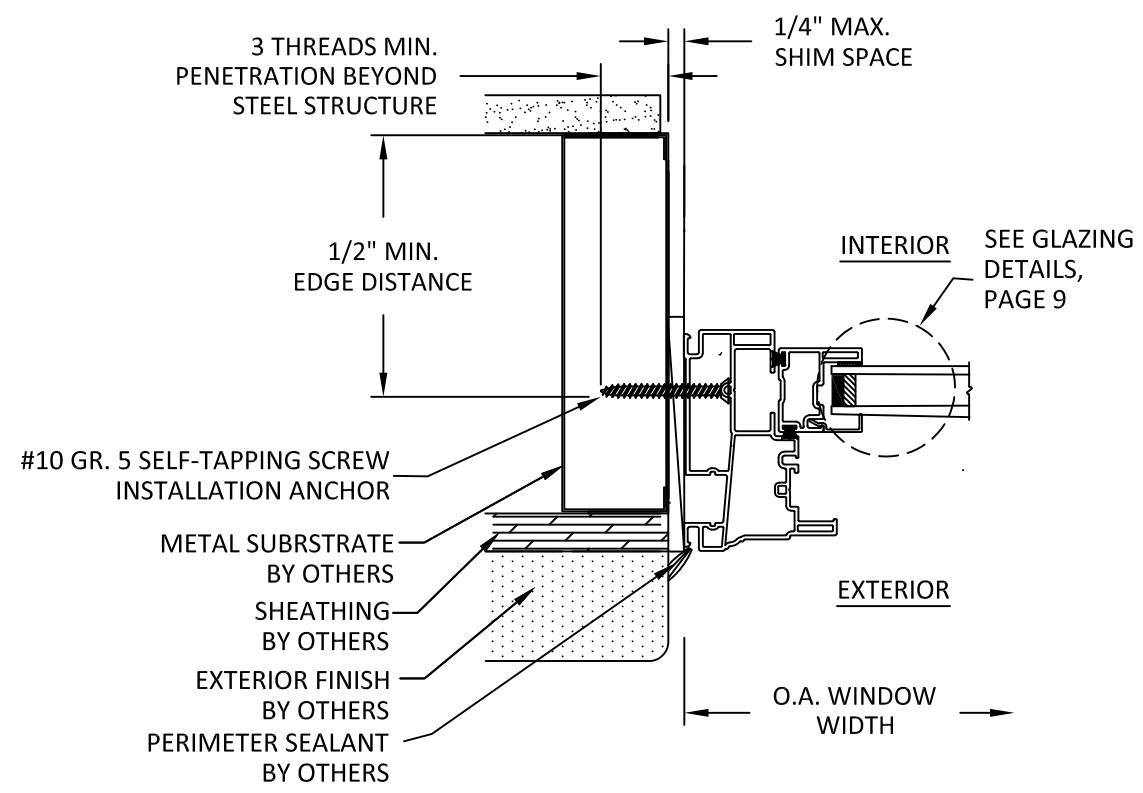

**B**  
**7**  
**HORIZONTAL SECTION**  
JAMB - STEEL STUD FRAME  
THROUGH FRAME INSTALLATION

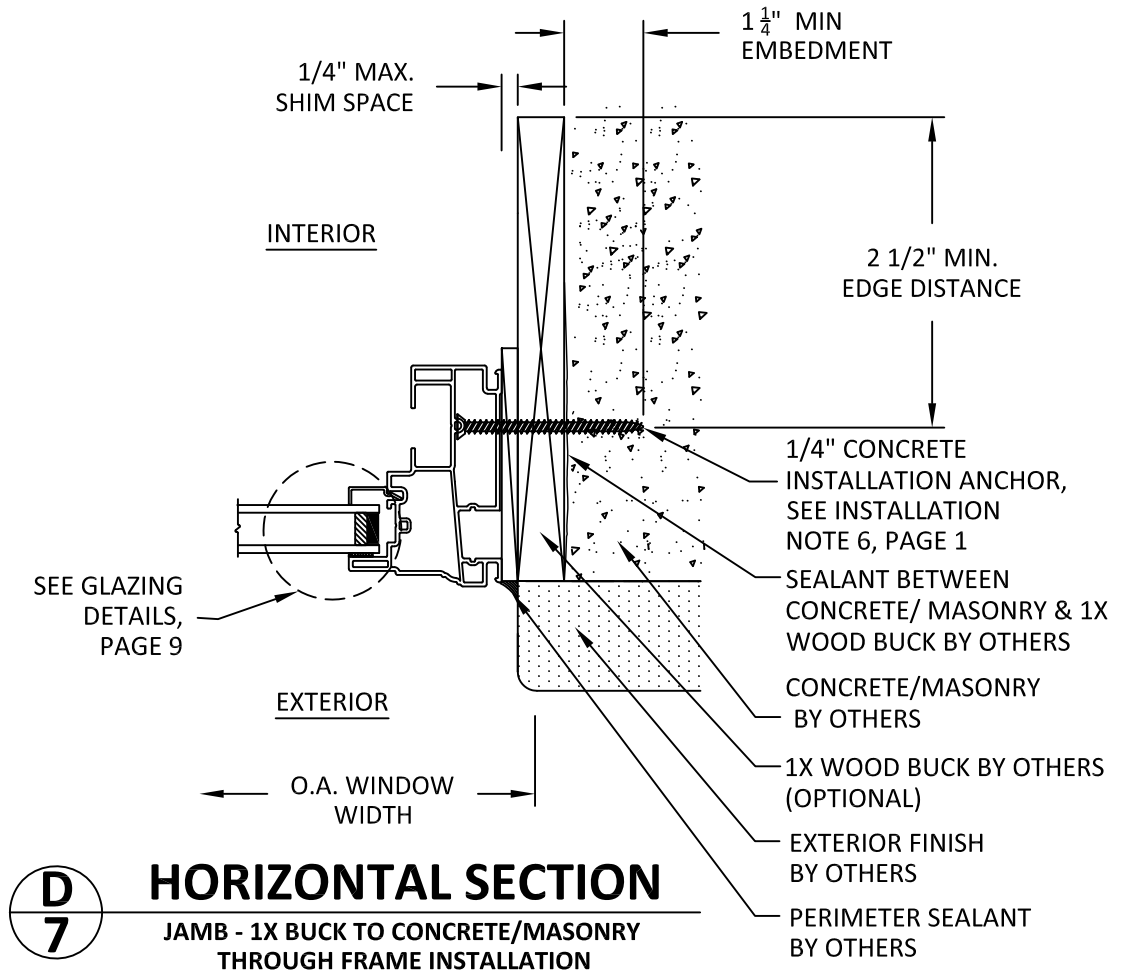

**D**  
**7**  
**HORIZONTAL SECTION**  
JAMB - 1X BUCK TO CONCRETE/MASONRY  
THROUGH FRAME INSTALLATION



**WINDSOR WINDOWS  
& DOORS**  
900 S. 19TH STREET.  
WEST DES MOINES, IA 50265  
PH: (515)223-6660 FAX: (515)224-1938

TITLE: NEXT DIMENSION CLASSIC  
SINGLE HUNG  
(NON-HVHZ)(NON-IMPACT)  
THROUGH FRAME & CLIP INSTALLATION  
SECTIONS

PREPARED BY:  
**BUILDING DROPS, INC.**  
398 E. DANIA BEACH BLVD., STE. 338  
DANIA BEACH, FL 33004  
PH: (954)399-8478  
FAX: (954)744-4738  
WEB: www.buildingdrops.com

| REMARKS | BY | DATE |
|---------|----|------|
|         |    |      |
|         |    |      |
|         |    |      |
|         |    |      |

THE INSTALLATION DETAILS DESCRIBED HEREIN ARE GENERIC  
AND MAY NOT REFLECT ACTUAL CONDITIONS FOR A SPECIFIC  
SITE. IF SITE CONDITIONS CAUSE INSTALLATION TO DEVIATE  
FROM THE REQUIREMENTS DETAILED HEREIN, A LICENSED  
ENGINEER OR ARCHITECT SHALL PREPARE SITE SPECIFIC  
DOCUMENTS FOR USE WITH THIS DOCUMENT.

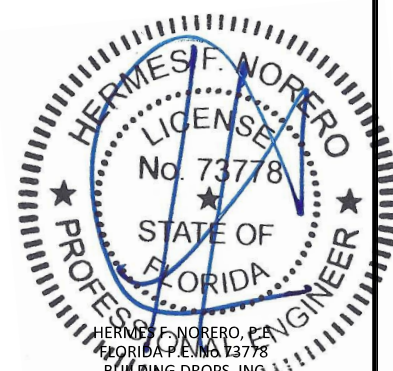

HERMES F. NORERO, P.E.  
FLORIDA P.E. NO. 73778  
BUILDING DROPS, INC.  
398 E. DANIA BEACH BLVD. # 338  
DANIA BEACH, FL 33004  
FBPE CERT. OF AUTHORIZATION No. 29578

|          |  |          |  |
|----------|--|----------|--|
| FL #:    |  | FL14884  |  |
| DATE:    |  | 11.02.20 |  |
| DWG. BY: |  | CHK. BY: |  |
| NUS      |  | HFN      |  |
| SCALE:   |  | NTS      |  |
| DWG. #:  |  | WWD058   |  |
| SHEET:   |  |          |  |



12/22/2020 4:18 PM

s:\projects\windsor windows and doors\cc-20-0917-fbc code change (ver. 7)\dwg\114884\wwd058.dwg

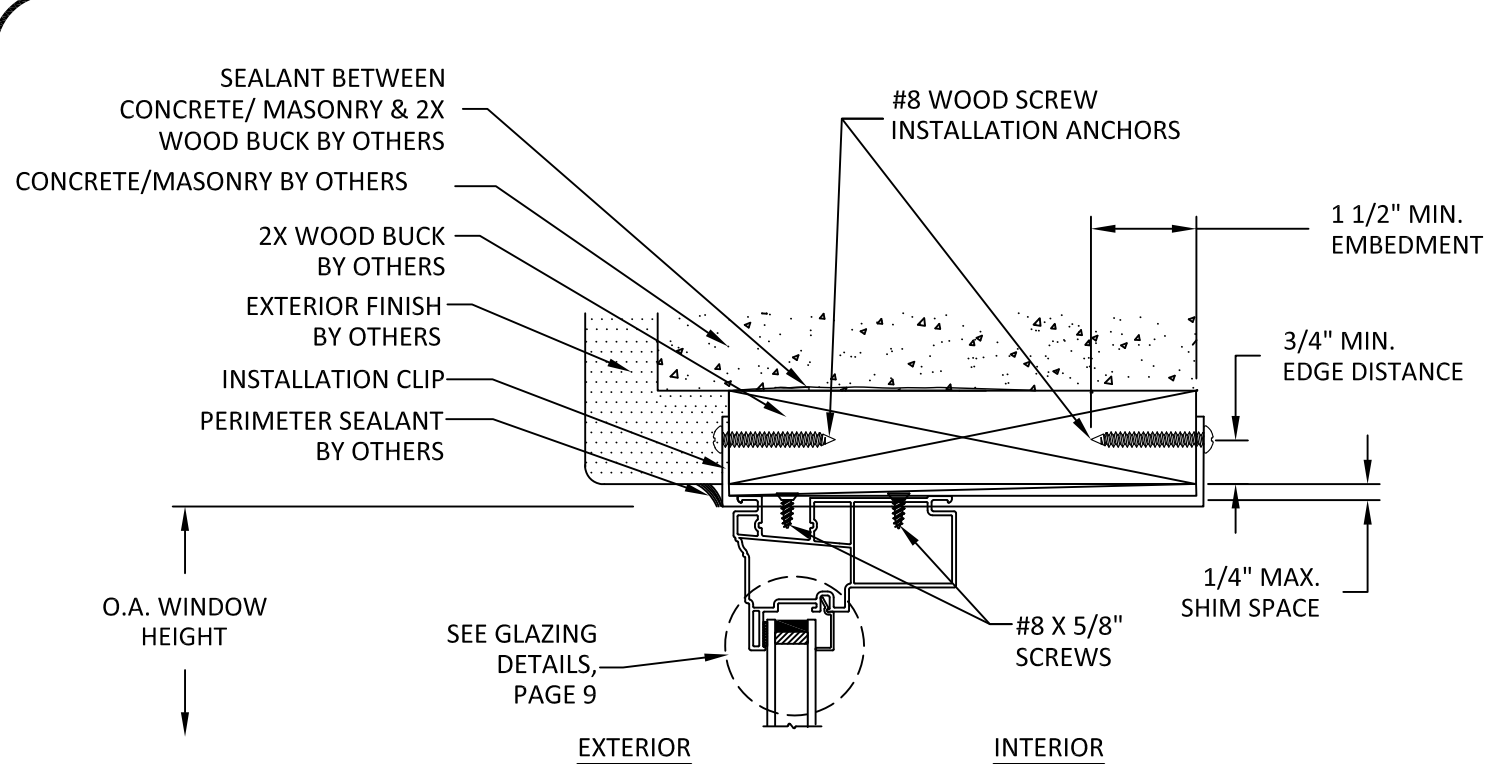

**A**  
**8** **VERTICAL SECTION**  
HEAD - 2X WOOD BUCK  
STANDARD CLIP INSTALLATION

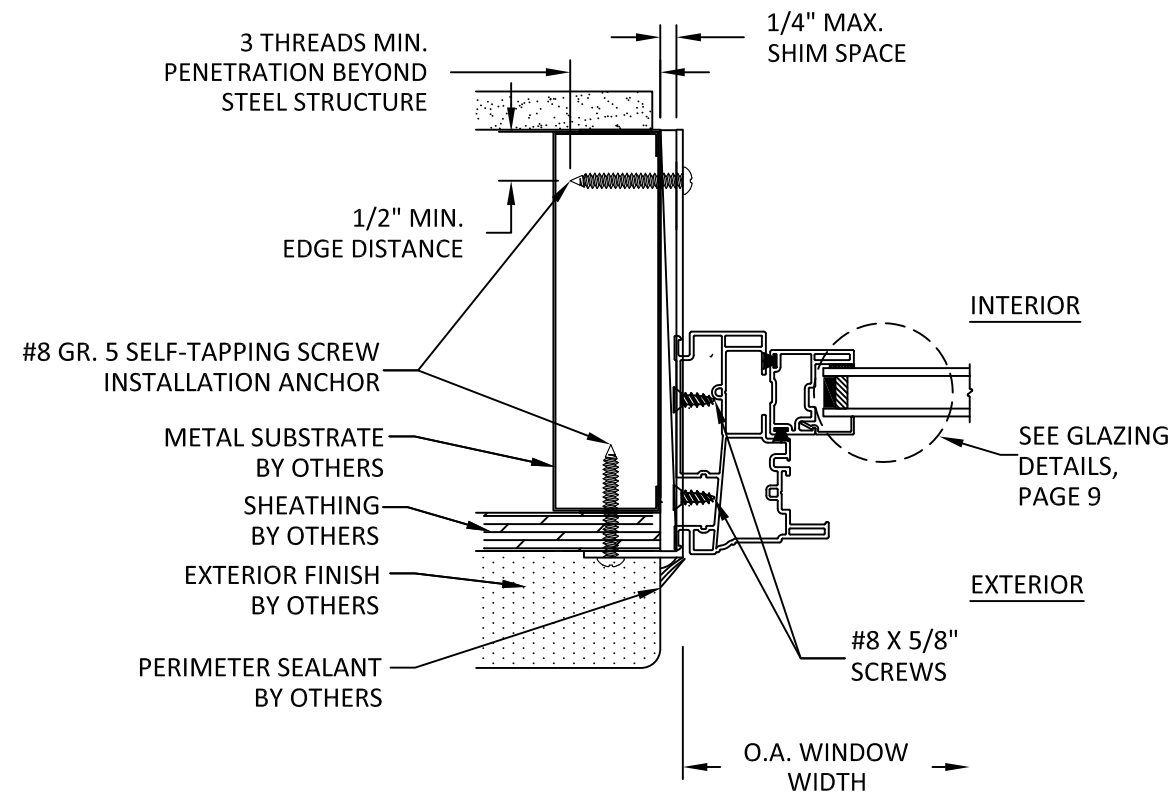

**B**  
**8** **HORIZONTAL SECTION**  
JAMB - STEEL STUD FRAME  
ALTERNATE CLIP INSTALLATION

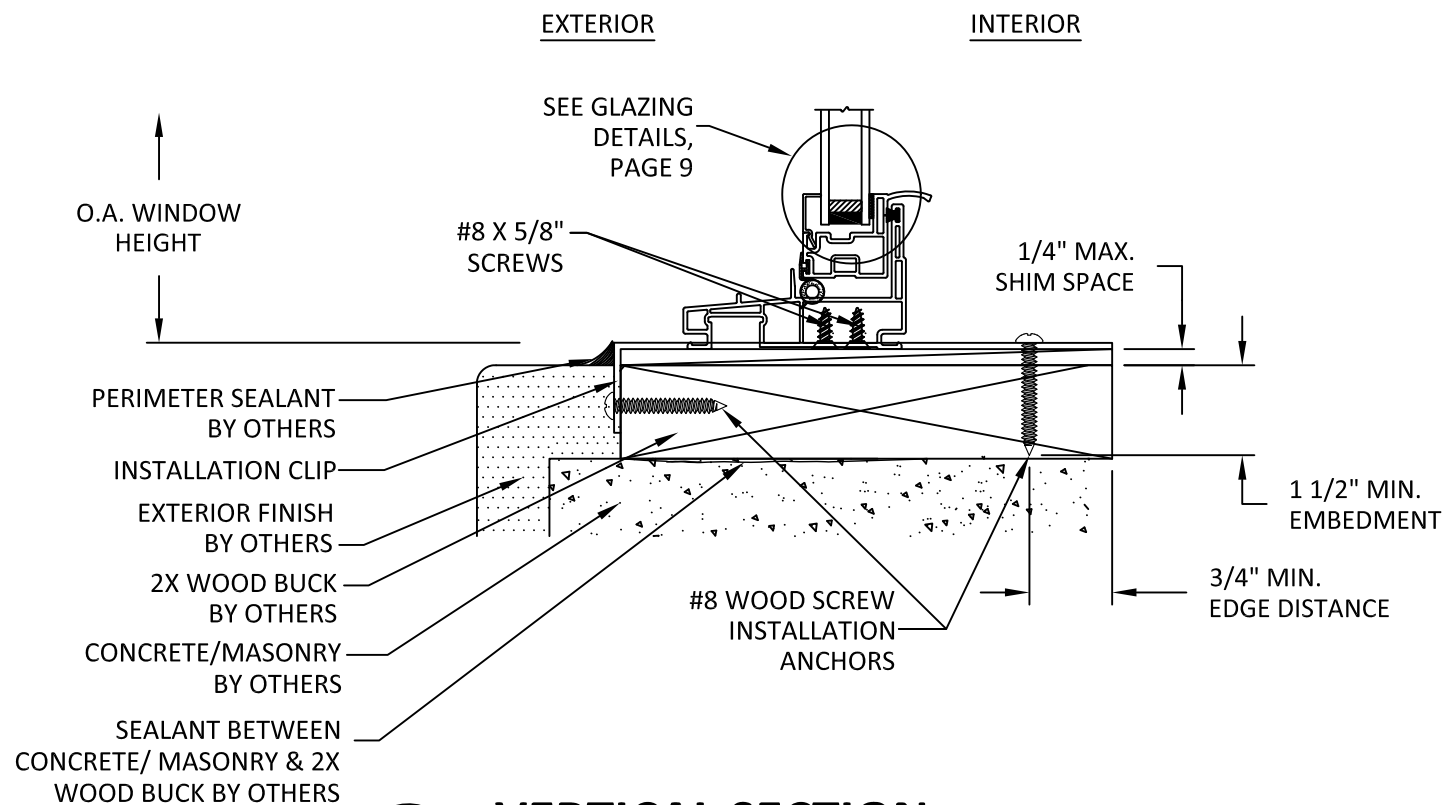

**C**  
**8** **VERTICAL SECTION**  
SILL - 2X WOOD BUCK  
ALTERNATE CLIP INSTALLATION

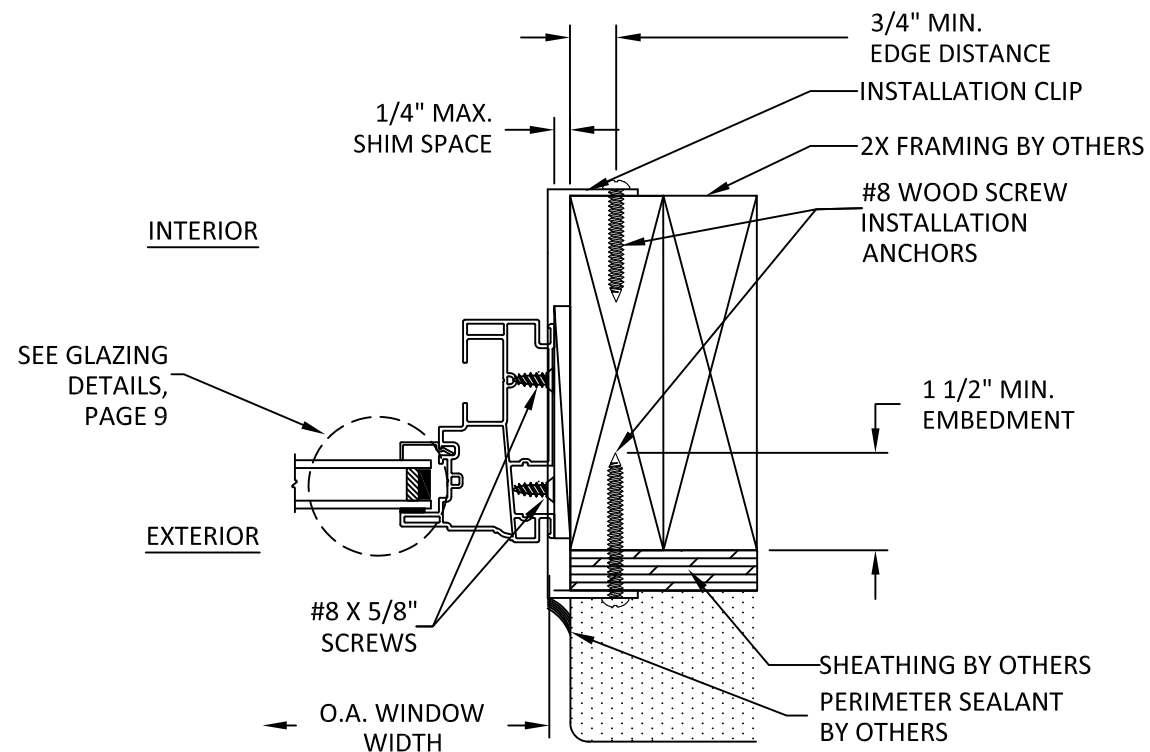

**D**  
**8** **HORIZONTAL SECTION**  
JAMB - 2X FRAMING  
STANDARD CLIP INSTALLATION



**WINDSOR WINDOWS & DOORS**

900 S. 19TH STREET.  
WEST DES MOINES, IA 50265  
PH: (515)223-6660 FAX: (515)224-1938

TITLE: NEXT DIMENSION CLASSIC  
SINGLE HUNG  
(NON-HVHZ)(NON-IMPACT)  
CLIP INSTALLATION SECTIONS

PREPARED BY:  
**BUILDING DROPS, INC.**  
398 E. DANIA BEACH BLVD., STE. 338  
DANIA BEACH, FL 33004  
PH: (954)399-8478  
FAX: (954)744-4738  
WEB: www.buildingdrops.com



| REMARKS | BY | DATE |
|---------|----|------|
|         |    |      |
|         |    |      |
|         |    |      |
|         |    |      |

THE INSTALLATION DETAILS DESCRIBED HEREIN ARE GENERIC AND MAY NOT REFLECT ACTUAL CONDITIONS FOR A SPECIFIC SITE. IF SITE CONDITIONS CAUSE INSTALLATION TO DEVIATE FROM THE REQUIREMENTS DETAILED HEREIN, A LICENSED ENGINEER OR ARCHITECT SHALL PREPARE SITE SPECIFIC DOCUMENTS FOR USE WITH THIS DOCUMENT.

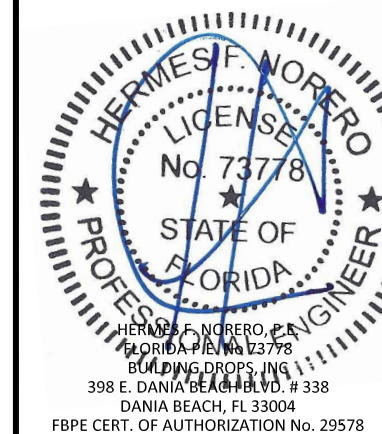

|          |                 |
|----------|-----------------|
| FL #:    | <b>FL14884</b>  |
| DATE:    | <b>11.02.20</b> |
| DWG. BY: | <b>NUS</b>      |
| CHK. BY: | <b>HFN</b>      |
| SCALE:   | <b>NTS</b>      |
| DWG. #:  | <b>WWD058</b>   |
| SHEET:   | <b>8</b>        |





WINDSOR WINDOWS  
& DOORS

900 S. 19TH STREET.  
WEST DES MOINES, IA 50265  
PH: (515)223-6660 FAX: (515)224-1938

TITLE: NEXT DIMENSION CLASSIC  
SINGLE HUNG  
(NON-HVHZ)(NON-IMPACT)

LOCK RAIL DETAIL, MULLION DETAIL,  
AND GLAZING DETAIL

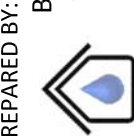

PREPARED BY:

BUILDING DROPS, INC.

398 E. DANIA BEACH BLVD., STE. 338  
DANIA BEACH, FL 33004

PH: (954)399-8478  
FAX: (954)744-4738  
WEB: www.buildingdrops.com

| REMARKS | BY | DATE |
|---------|----|------|
|         |    |      |
|         |    |      |
|         |    |      |
|         |    |      |

THE INSTALLATION DETAILS DESCRIBED HEREIN ARE GENERIC  
AND MAY NOT REFLECT ACTUAL CONDITIONS FOR A SPECIFIC  
SITE. IF SITE CONDITIONS CAUSE INSTALLATION TO DEVIATE  
FROM THE REQUIREMENTS DETAILED HEREIN, A LICENSED  
ENGINEER OR ARCHITECT SHALL PREPARE SITE SPECIFIC  
DOCUMENTS FOR USE WITH THIS DOCUMENT.

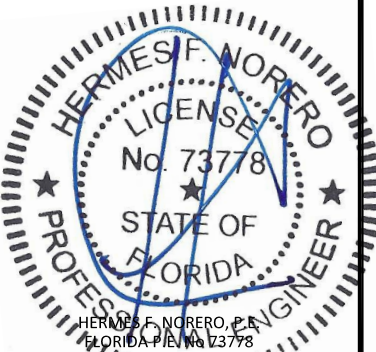

HERMES F. NORERO, P.E.  
FLORIDA P.E. NO. 73778  
BUILDING DROPS, INC.  
398 E. DANIA BEACH BLVD. # 338  
DANIA BEACH, FL 33004  
FBPE CERT. OF AUTHORIZATION No. 29578

FL #:  
**FL14884**

DATE: **11.02.20**

DWG. BY:  
**NUS**

CHK. BY:  
**HFN**

SCALE: **NTS**

DWG. #: **WWD058**

SHEET:  
**9**

OF 9

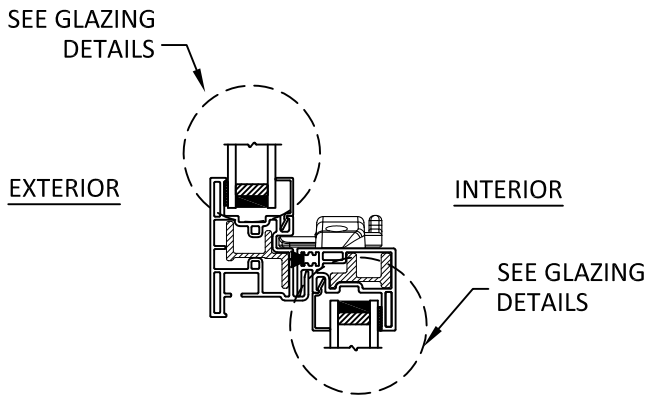

**A**  
**9**  
**LOCK RAIL**  
SINGLE HUNG  
SWEEP LOCK

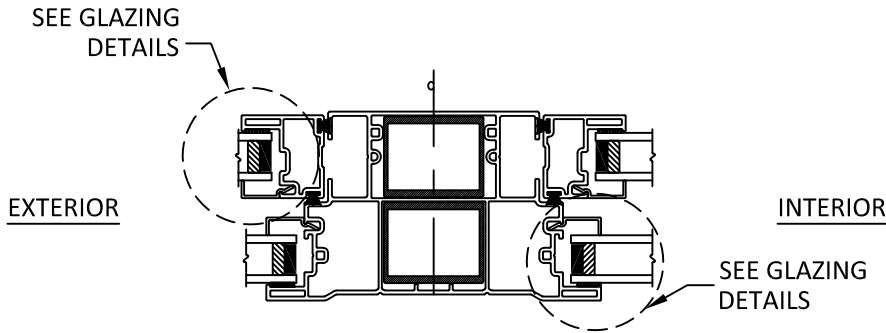

**B**  
**9**  
**VERTICAL MULLION**

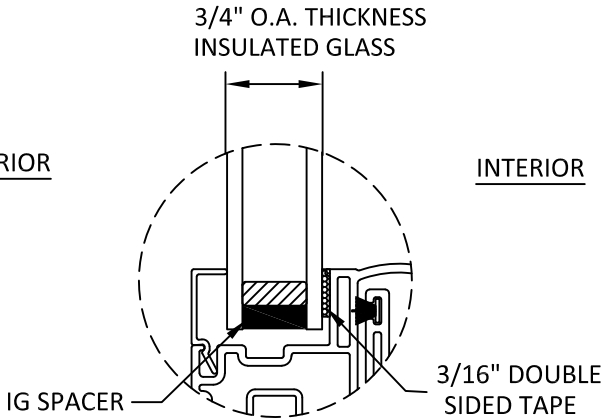

**GLAZING DETAIL**

- GLAZING NOTES:
- GLASS TYPE & THICKNESS SHALL COMPLY WITH ASTM E1300 REQUIREMENTS AS WELL AS APPLICABLE SAFETY GLAZING REQUIREMENTS PER THE IBC/IRC. TEMPER AND SAFETY GLAZING REQUIREMENTS SHALL BE REVIEWED ON A SITE SPECIFIC BASIS.
  - SETTING BLOCK DUROMETER HARDNESS OF 70-90 (SHORE A).
  - SETTING BLOCKS TO BE LOCATED AT 1/4 SPAN LENGTH FOR GLASS WIDER THAN 36".
  - DESIGN PRESSURES MAY NOT EXCEED MAX VALUES IN DESIGN PRESSURE TABLE ON SHEET 1.